



# City of Cambridge

IN CITY COUNCIL

March 22, 1976

WHEREAS The Commissioner of Public Works (hereinafter called the Commissioner) has recommended that the proposed Walden Square Neighborhood Facility (hereinafter called the Facility) be constructed on a parcel (hereinafter called the Parcel) of City-owned land currently in his charge and described as follows:

Starting at the southeast corner of property now or formerly owned by Anthony G. & Roberta M. Kalinoski, thence proceeding southerly approximately 282 feet along the western right of way line of Sherman Street to the northeast corner of property now or formerly owned by John & Sarah McGeorghean; thence proceeding westerly approximately 150 feet along the northern line, and the extension thereof, of said McGeorghean property; thence proceeding northerly approximately 307 feet across property owned by the City of Cambridge to the southern line of property now or formerly owned by Wilson H. & Mary P. Raines; thence proceeding easterly approximately 150 feet along the southern property lines of said Raines & Kalinoski properties to the point of beginning; and

WHEREAS A portion of the Parcel is currently used as a neighborhood parking lot (commonly known as and hereinafter called the Sherman Street Neighborhood Parking Lot), the remaining portion of the Parcel being currently unused and vacant; and

WHEREAS The plans for the Sherman Street Neighborhood Facility, as included with the attached memorandum of March 12, 1976 from the Commissioner to the City Manager, provide for continued neighborhood parking on the Parcel, in conjunction with the new Facility; and

WHEREAS The Commissioner has determined that the Sherman Street Neighborhood Parking Lot is underutilized and that it is no longer necessary or advisable that it be devoted exclusively to parking lot use; and

WHEREAS The City Manager has concurred in the Commissioner's determination and recommendation.

NOW, THEREFORE, in accordance with Massachusetts General Laws Chapter 40, Section 15A, it is hereby ORDERED that the care, custody, management and control of the Parcel be transferred to the Commissioner for use in the development of the Facility and the related access road.

in City Council May 3, 1976

Adopted by yeas and nays Vote

Yeas 6 Nays 3 Absent 0

Paul E. Leahy  
City Clerk



# City of Cambridge

IN CITY COUNCIL

March 22, 1976

WHEREAS The Commissioner of Public Works (hereinafter called the Commissioner) has recommended that the proposed Walden Square Neighborhood Facility (hereinafter called the Facility) be constructed on a parcel (hereinafter called the Parcel) of City-owned land currently in his charge and described as follows:

Starting at the southeast corner of property now or formerly owned by Anthony G. & Roberta M. Kalinoski, thence proceeding southerly approximately 282 feet along the western right of way line of Sherman Street to the northeast corner of property now or formerly owned by John & Sarah McGeorghean; thence proceeding westerly approximately 150 feet along the northern line, and the extension thereof, of said McGeorghean property; thence proceeding northerly approximately 307 feet across property owned by the City of Cambridge to the southern line of property now or formerly owned by Wilson H. & Mary P. Raines; thence proceeding easterly approximately 150 feet along the southern property lines of said Raines & Kalinoski properties to the point of beginning; and

WHEREAS A portion of the Parcel is currently used as a neighborhood parking lot (commonly known as and hereinafter called the Sherman Street Neighborhood Parking Lot), the remaining portion of the Parcel being currently unused and vacant; and

WHEREAS The plans for the Sherman Street Neighborhood Facility, as included with the attached memorandum of March 12, 1976 from the Commissioner to the City Manager, provide for continued neighborhood parking on the Parcel, in conjunction with the new Facility; and

WHEREAS The Commissioner has determined that the Sherman Street Neighborhood Parking Lot is underutilized and that it is no longer necessary or advisable that it be devoted exclusively to parking lot use; and -

WHEREAS The City Manager has concurred in the Commissioner's determination and recommendation.

NOW, THEREFORE, in accordance with Massachusetts General Laws Chapter 40, Section 15A, it is hereby ORDERED that the care, custody, management and control of the Parcel be transferred to the Commissioner for use in the development of the Facility and the related access road.

in City Council May 3, 1976

Adopted by yeas and nays Vote

Yeas 6 Nays 3 Absent 0

Paul E. Walsh  
City Clerk



# City of Cambridge

IN CITY COUNCIL

March 22, 1976

WHEREAS The Commissioner of Public Works (hereinafter called the Commissioner) has recommended that the proposed Walden Square Neighborhood Facility (hereinafter called the Facility) be constructed on a parcel (hereinafter called the Parcel) of City-owned land currently in his charge and described as follows:

Starting at the southeast corner of property now or formerly owned by Anthony G. & Roberta M. Kalinoski, thence proceeding southerly approximately 282 feet along the western right of way line of Sherman Street to the northeast corner of property now or formerly owned by John & Sarah McGeorghean; thence proceeding westerly approximately 150 feet along the northern line, and the extension thereof, of said McGeorghean property; thence proceeding northerly approximately 307 feet across property owned by the City of Cambridge to the southern line of property now or formerly owned by Wilson H. & Mary P. Raines; thence proceeding easterly approximately 150 feet along the southern property lines of said Raines & Kalinoski properties to the point of beginning; and

WHEREAS A portion of the Parcel is currently used as a neighborhood parking lot (commonly known as and hereinafter called the Sherman Street Neighborhood Parking Lot), the remaining portion of the Parcel being currently unused and vacant; and

WHEREAS The plans for the Sherman Street Neighborhood Facility, as included with the attached memorandum of March 12, 1976 from the Commissioner to the City Manager, provide for continued neighborhood parking on the Parcel, in conjunction with the new Facility; and

WHEREAS The Commissioner has determined that the Sherman Street Neighborhood Parking Lot is underutilized and that it is no longer necessary or advisable that it be devoted exclusively to parking lot use; and

WHEREAS The City Manager has concurred in the Commissioner's determination and recommendation.

NOW, THEREFORE, in accordance with Massachusetts General Laws Chapter 40, Section 15A, it is hereby ORDERED that the care, custody, management and control of the Parcel be transferred to the Commissioner for use in the development of the Facility and the related access road.

in City Council May 3, 1976

Adopted by yeas and nays Vote

Yeas 6 Nays 3 Absent 0

*Paul E. Husby*  
City Clerk

# City of Cambridge

MASSACHUSETTS

In City Council May 3 1976

*Dudley L. Freeman re NEWSITE FOR CENTER*

	YEA	NAY	ABSENT	PRESENT
Mrs. Ackermann	✓			
Mr. Clem	✓			
Mr. Clinton		✓		
Mr. Danehy		✓		
Mr. Duhay	✓			
Mrs. Graham	✓			
Mr. Russell	✓			
Mr. Sullivan		✓		
Mayor Vellucci	✓			

6 3 0

*Ch S M*  

---

*RT*  
*A*

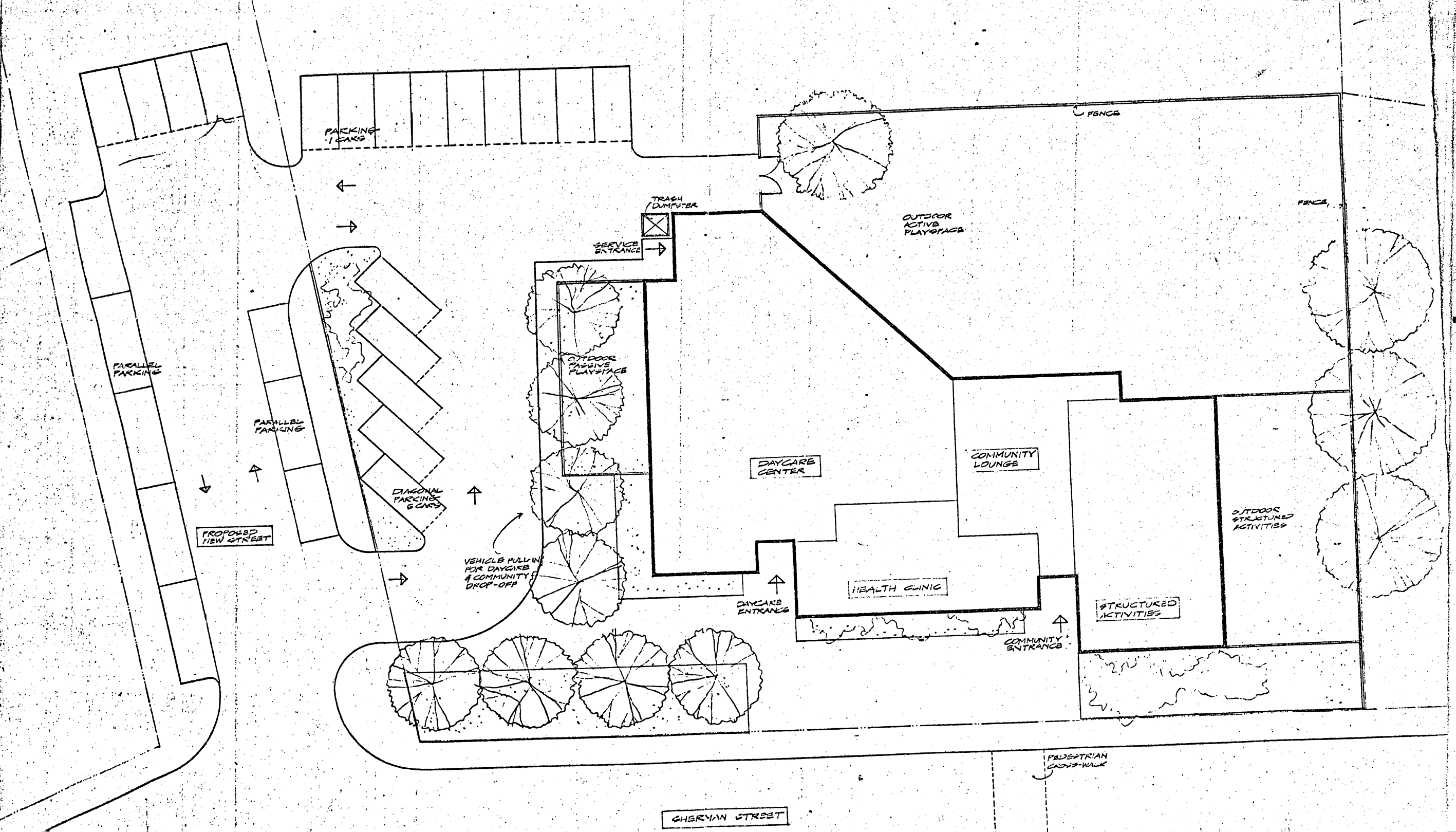



DEPARTMENT OF HOUSING AND URBAN DEVELOPMENT

AREA OFFICE  
15 NEW CHARDON STREET  
BOSTON, MASSACHUSETTS 02114

AREA OFFICES  
Boston, Massachusetts  
Hartford, Connecticut  
Manchester, New Hampshire

REGION I  
REGIONAL OFFICE  
BOSTON, MASSACHUSETTS

IN REPLY REFER TO:

1.1CM:SG

Mr. James L. Sullivan  
City Manager  
City Hall  
Cambridge, Massachusetts 02139

MAR 22 1976

Dear Mr. Sullivan:

Subject: Neighborhood Facilities Grant Program  
Project No. NFP-MA-01-06-1010  
Walden Square

We have received a letter from Mr. Alan Zimlicki of your Community Development Department dated January 8, 1976 in which a site change was proposed for the subject project.

It was our understanding that the development of this project should have been completed or at least be well along the way, based upon the development schedule submitted by the City in April 1975 which estimated completion by June 30, 1976.

We conducted a meeting on February 13, 1976 with members of your Community Development staff to determine the progress made by the City in developing this facility and what actions are being taken to complete the project. The actions proposed were (1) to obtain the City's approval in changing the site; (2) to obtain plans and specifications for the facility and subsequently contract for construction. No conclusions were reached in terms of the ability of the City to complete the project within the original grant limitations.

This office has no objection to the proposed site change, provided

1. The site change does not result in an increase in the approved Federal grant.
2. Any overruns in construction costs will be borne by the City.
3. A City Council resolution approving the change is submitted to HUD.

Furthermore, because of the extended delay in getting this project underway (original agreement executed August 29, 1973), a contract for the construction of this facility must be entered into by June

1944

2

30, 1976. If this date is not met we will proceed to terminate the grant agreement and cancel the categorical fund reservation for this project.

Sincerely,

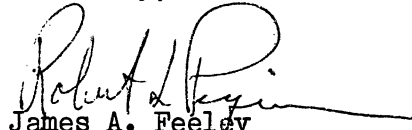
  
James A. Feely  
Director  
Community Planning and  
Development Division

March 24, 1976

City Council Members  
Cambridge City Hall  
Cambridge, Massachusetts

Dear Sir:

The following is an explanation of the concerns the abutters have of the new Sherman Street facility.

We feel that the building as explained to us would be an asset to the neighborhood as opposed to the state of the parking lot as it now stands. The only concern in this area is the drainage problems which we were told would be dealt with. At this point our yards become flooded after a heavy rain due to the height of the land in the parking lot area.

We are not opposed to the concept of a day care center or a health center. These are much needed services. We are definitely opposed to the suggested use of the third component in this facility. With four Community Schools programs within walking distance we do not feel that the Community Schools program needs still another building from which to operate. We fear that because of the nature of Community Schools, that it must serve the desires of all groups in the area, that very little supervision would or could be involved in the programming. This could conceivably become a place where "kids" would "hang out". Because of past problems it does not make sense to knowingly bring this upon the neighborhood.

We would not object to more structured use of the third component such as adult education classes, or classes where skills could be acquired and be open to not only the entire neighborhood but utilized city wide. We are not discussing here those types of classes as mentioned in the plans which just seem to be an open invitation to building in purely space for recreation.

We believe that this area of the city needs more services not recreational facilities of which there are many, both indoor and outdoor.

We hope that you will take these suggestions into consideration when this again comes before the City Council. We would also like to thank the City Council for putting off the vote on this project until the neighbors had a chance to respond.

Sincerely,

*Anthony Kalinoski*  
*Robert Kalinoski*

Mr. and Mrs. Anthony Kalinoski  
111 Sherman Street

Mr. and Mrs. William Lee  
6 Bellis Circle

# City of Cambridge

MASSACHUSETTS

Agenda #7 Re: to the Walden Square  
Neighborhood Center.

In City Council March 22 1976

	YEA	NAY	ABSENT	PRESENT
Mrs. Ackermann				
Mr. Clem				
Mr. Clinton				
Mr. Danehy				
Mr. Duehay				
Mrs. Graham				
Mr. Russell				
Mr. Sullivan				
Mayor Vellucci				

# SHERMAN STREET NEIGHBORHOOD FACILITY SITE CHANGE

ORIGINAL  
SITE

PROPOSED  
SITE

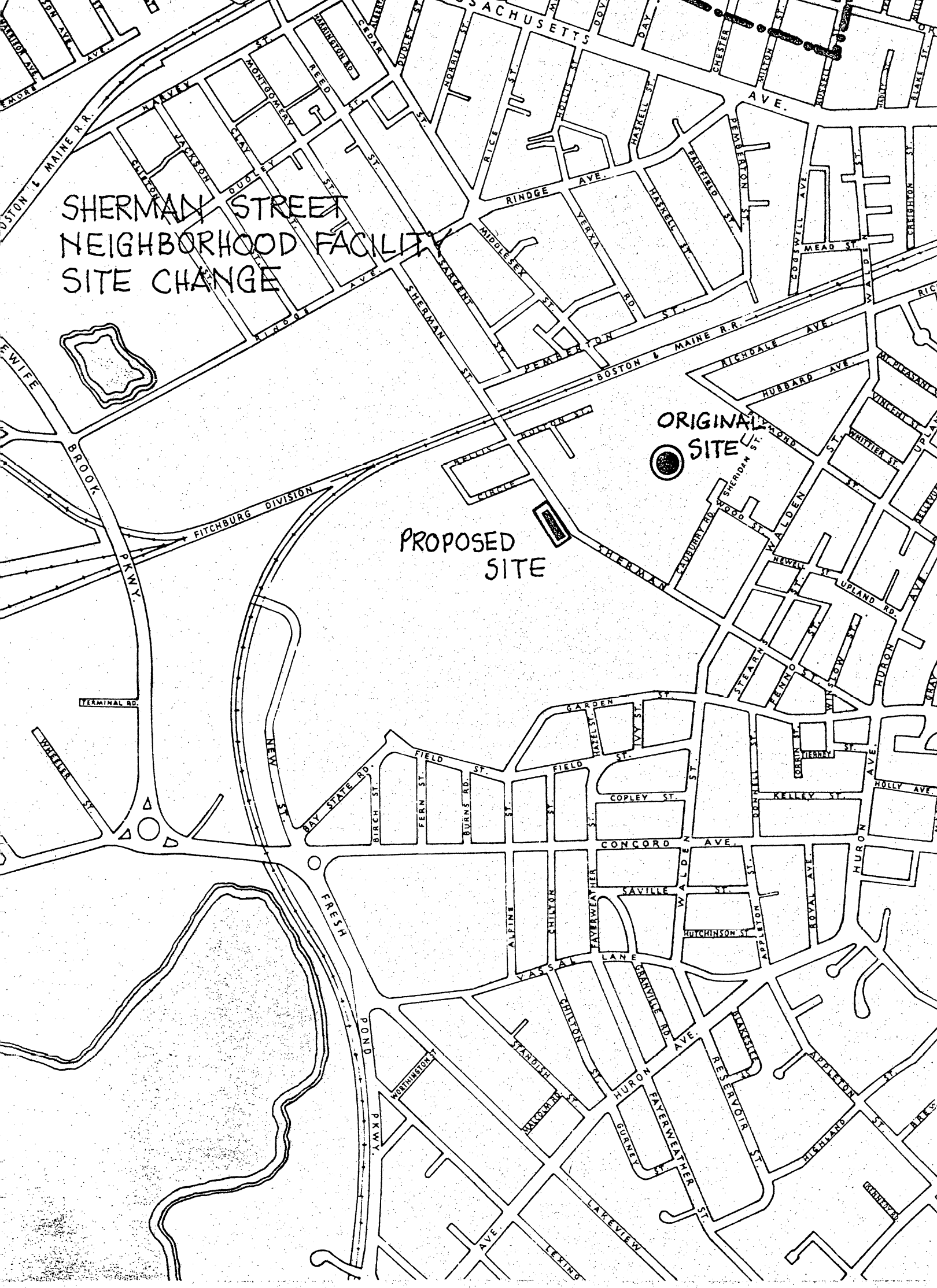

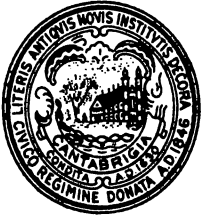

## CITY OF CAMBRIDGE

CAMBRIDGE, MASSACHUSETTS 02139  
Tel. 876-6800

EXECUTIVE DEPARTMENT  
JAMES L. SULLIVAN  
City Manager

March 22, 1976

To the Honorable, the City Council:

One of the larger public investment fund projects scheduled this fiscal year is the Walden Square Neighborhood Center.

This facility was originally scheduled to be located on a site within the Walden Square Urban Renewal project. However, this site was too small and the access inadequate for use by the larger neighborhood.

Another site has been found which satisfies all important requirements and is acceptable to the neighborhood. The site is on City-owned land on the Sherman Street side of the old clay pit, and is partially occupied by a neighborhood parking lot developed by the City several years ago.

The enclosed site plan for the development accommodates neighborhood parking as well as parking for the center. The site plan also accommodates a right of way for access to future development on the old dump beyond the site, as called for in the recently proposed dump site re-use plan.

Enclosed is a report from the Commissioner of Public Works, who has responsibility for this land, that the land is underused and not needed solely for its present use.

Also enclosed is a letter from the Director of the Boston Area Office of HUD stating that HUD has no objection to the change in site location as long as the City Council approves. HUD is funding two-thirds of the project costs.

In my judgment, the proposed development would be a distinct asset on that site. It will put underutilized marginal land into productive community use at the same time that it will continue to serve an existing neighborhood need. Consequently, I recommend passage of the attached Council Order authorizing this change in specified use of City-owned land. I call your attention to the fact that a two-thirds vote of the Council is required for adoption of such an order.

Very truly yours,

  
JAMES L. SULLIVAN  
City Manager

Re: to the Walden Square Neighborhood Center.

*5/3/76 Committee  
Report  
Received*

*5/3/76 Order  
Adopted  
after  
Hearing  
6-3-0*

*LFJR  
RF  
A*

In City Council,  
March 22, 1976

*3/22/76 Motion +  
Place on file  
Report to the  
LAWSON RECORDS*