



CITY OF CAMBRIDGE  
COMMUNITY DEVELOPMENT DEPARTMENT  
City Hall Annex - Inman & Broadway - Cambridge, Mass. 02139

498-9034

May 26, 1987

To: Randy Fusharo, Geographer  
Arthur Dukakis, Regional Director  
Bureau of the Census

From: Randall Wilson, Planning Data Manager *RW*  
Cambridge Community Development Department

Subject: Census Tract Boundary Revisions

This note is to confirm the changes proposed for boundary lines between census tracts in the City of Cambridge. The revised boundaries will better conform to public roadways and other recognizable features. The changes are illustrated on the enclosed maps and summarized below:

- Block 201, Census Tract 3547/Block 102, Census Tract 3545.

Old Boundary: from B & M Railroad tracks north to Somerville Avenue.

New Boundary: absorb Block 201 into Block 102, Census Tract 3545; boundary of 3545 will extend westward into intersection of Massachusetts Avenue and Somerville Avenue.

- Block 505, Census Tract 3537/Block 405, Census Tract 3536.

Old Boundary: area between intersection of Oxford Street and Kirkland Street and Cambridge Street.

New Boundary: absorb Block 505 into Block 405, Census Tract 3536. Extend boundary of 3536 from Kirkland and Quincy Streets to Quincy and Cambridge Streets, and west on Cambridge Street to its terminus.

- Block 311, Census Tract 3531/Block 101, Census Tract 3532.

Old Boundary: area between Brookline and Sidney Streets, beyond the end of Auburn Street.

New Boundary: absorb Block 311 into Block 101, Census Tract 3532. Extend boundary of 3532 from Brookline and Auburn Streets, north on Brookline, east on Franklin to Sidney, Street and south on Sidney Street.

- Block 216, Census Tract 3521/Block 101, Census Tract 3522.

Old Boundary: area between Winter Street, east of Fifth Street, north to the Somerville line.

New Boundary: retain Block 216 in Census Tract 3521. Extend boundary between Block 216/Census Tract 3521 and Block 101/Census Tract 3522 from Fifth Street north to the Somerville line.

Thank you for your assistance in this matter. Please contact me if you have any questions.

RW/gb

Enclosure

cc: Board of Election Commissioners  
Guy DeLuca, School Department  
Joseph Connerton, City Clerk

# CAMBRIDGE CENSUS TRACTS AND BLOCKS - 1980

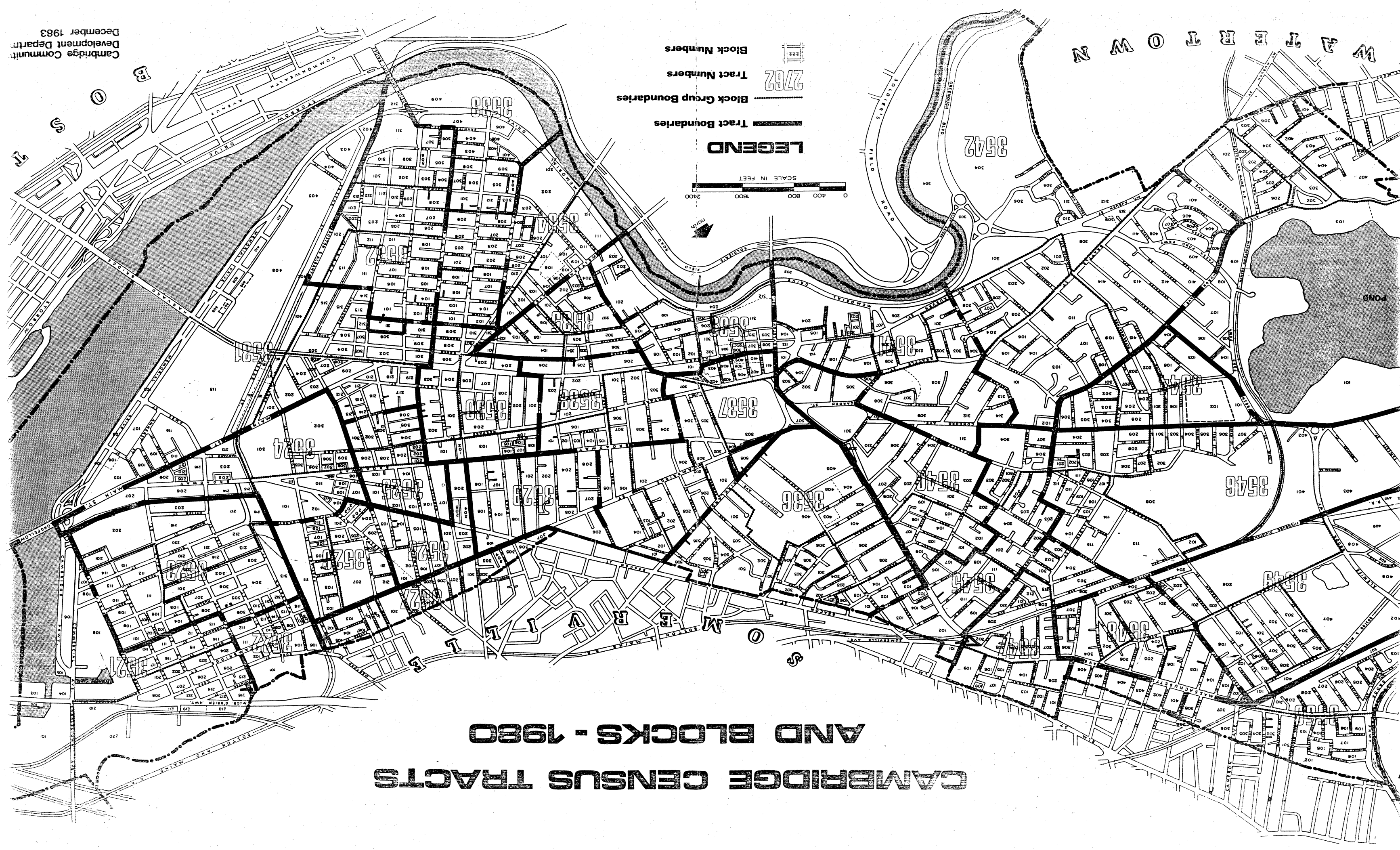

**LEGEND**

- Tract Boundaries
- Block Group Boundaries
- Tract Numbers
- Block Numbers

SCALE IN FEET  
2400 1600 800 400



Cambridge Community  
Development Department  
December 1983

W A T E R T O W N

E M B L E T

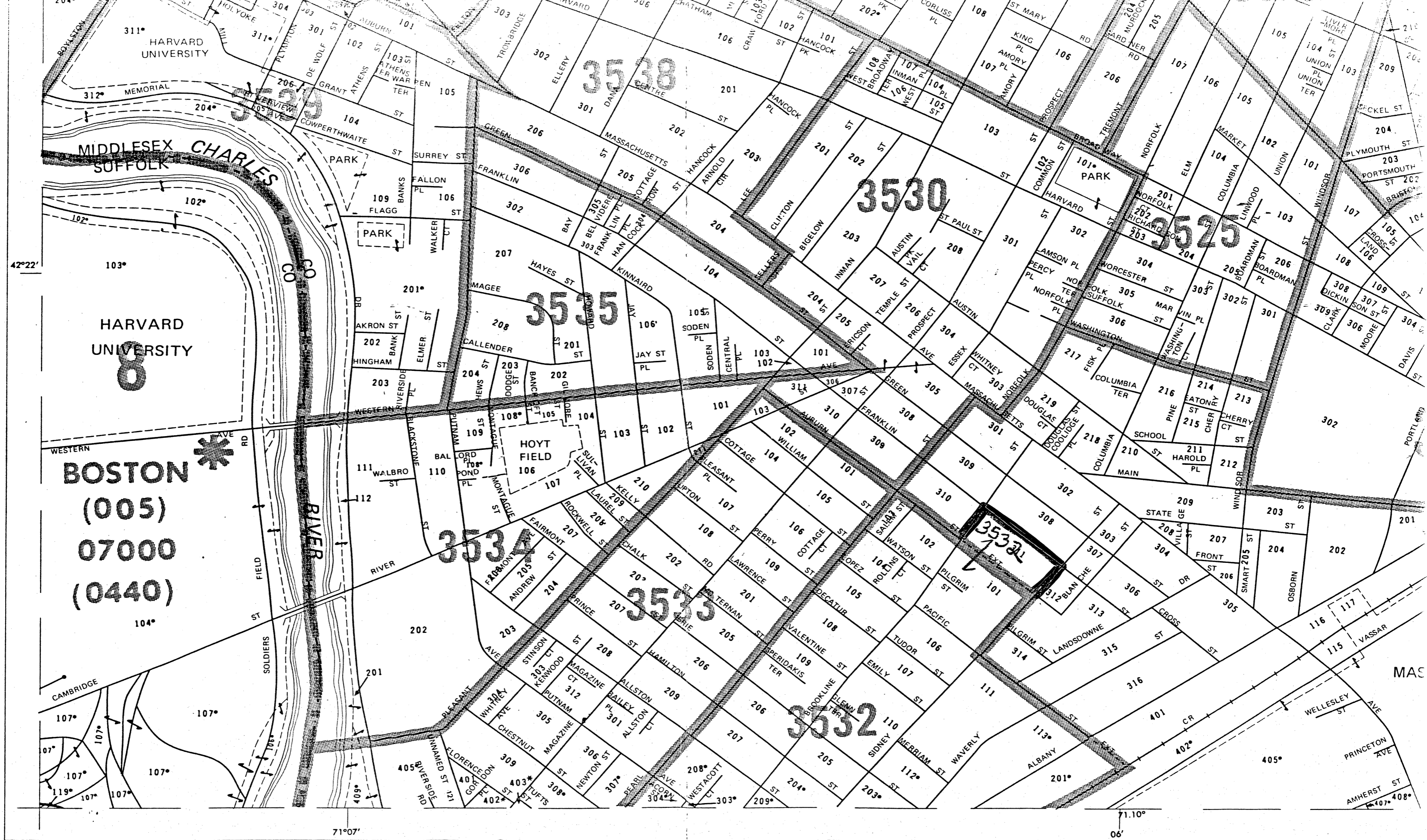

 SUGGESTED REVISION

SUGGESTED REVISION

# SOMERVILLE

## 3515

(1935)  
62525  
(1920)

MILLERS

## 3525

### DONNELLY FIELD

## 3527

## 3528

## 3522

### PARK

## 3529

## 3530

## 3512

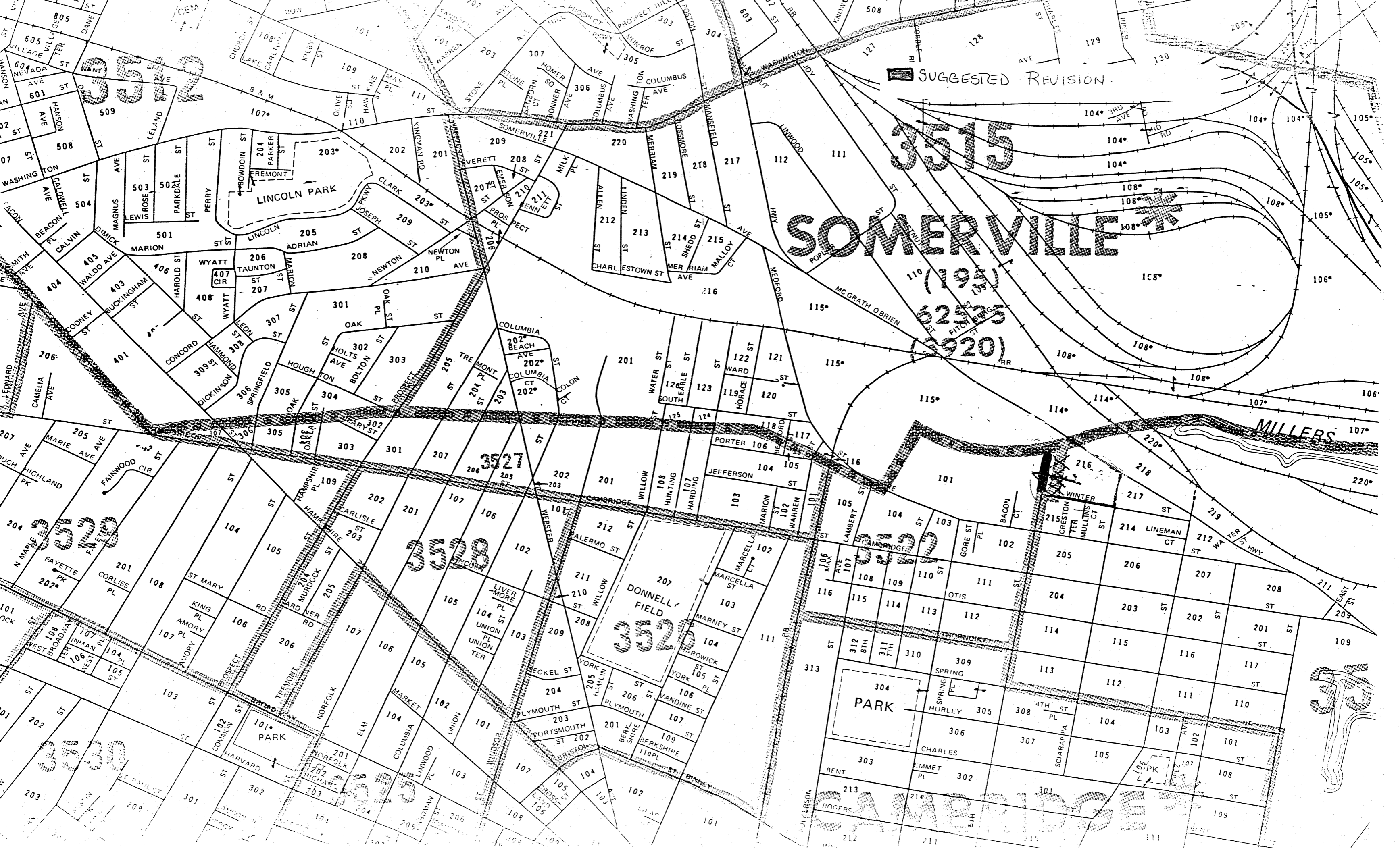

 SUGGESTED REVISION

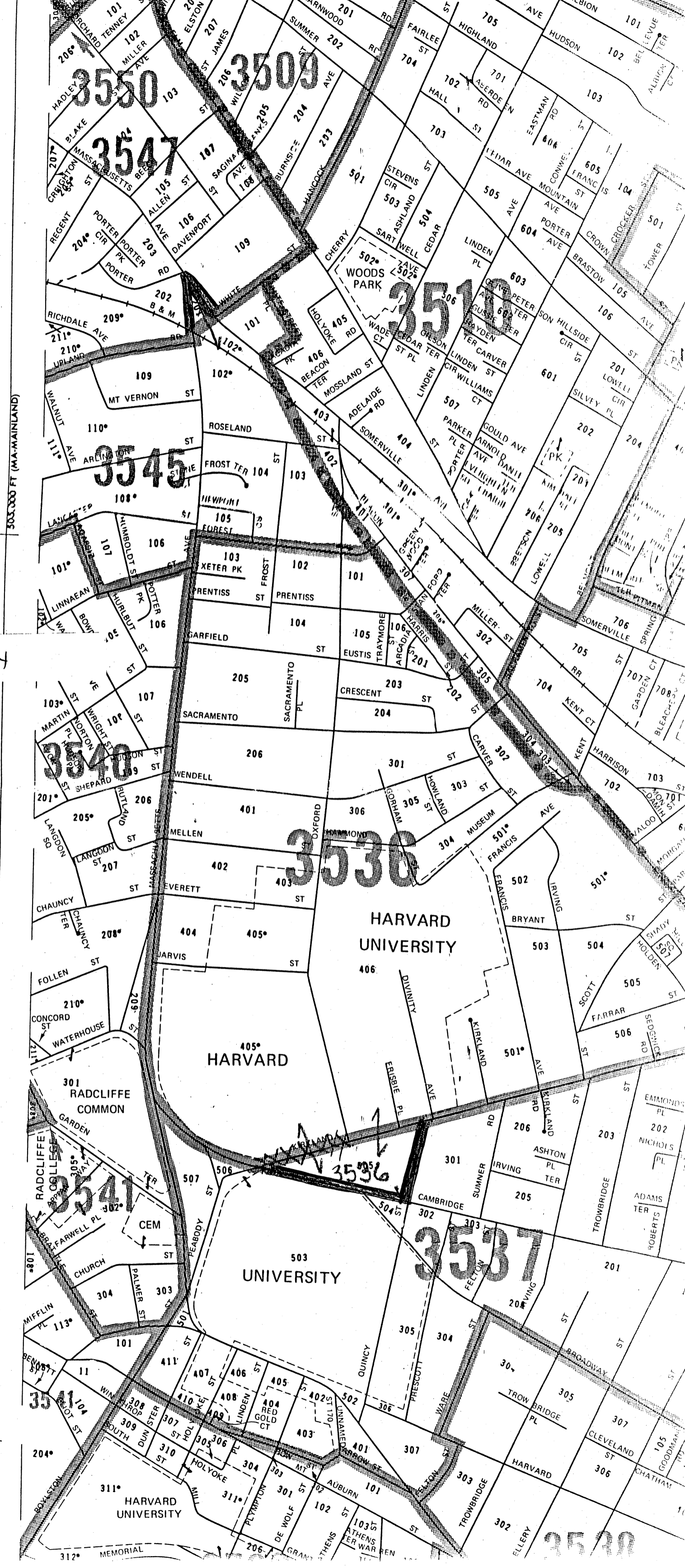

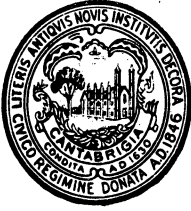

498-9034

**CITY OF CAMBRIDGE**  
**COMMUNITY DEVELOPMENT DEPARTMENT**  
City Hall Annex - Inman & Broadway - Cambridge, Mass. 02139  
RECEIVED BY  
OFFICE OF CITY CLERK  
MAY 29 PM 6:01  
CAMBRIDGE MA.

May 29, 1987

TO: Joseph Connerton  
City Clerk

FROM: Randall Wilson *RW*  
Planning Data Manager

RE: Revised Census Tract Boundaries

After discussions with the US Bureau of the Census, we have agreed upon several changes in the city's census tract boundaries. The new boundaries more closely follow public roadways. For your information, I have enclosed a memo and maps detailing these revisions. Please contact me if you have any questions or comments.



S-364

Comm. from Randall Wilson, Planning Data  
Mgr., Community Development Dept. Re: re-  
vised census tract boundaries.

May 29, 1987