

Put with Order # 19.

**Environmental Notification
Form
Historic Parkways Initiative
Memorial Drive Demonstration
Project - Phase II
Cambridge, Massachusetts**

**Submitted by:
Metropolitan District
Commission**



**Submitted to:
Executive Office of
Environmental Affairs -
MEPA Office**

June 30, 2003

HISTORICAL AND ARCHAEOLOGICAL RESOURCES SECTION

I. Thresholds / Impacts

A. Is any part of the project site a historic structure, or a structure within a historic district, in either case listed in the State Register of Historic Places or the Inventory of Historic and Archaeological Assets of the Commonwealth? Yes ___ No; if yes, does the project involve the demolition of all or any exterior part of such historic structure? Yes ___ No; if yes, please describe:

A Project Notification Form (PNF) has been filed with the Massachusetts Historical Commission (MHC). A copy of the PNF is included in Appendix E.

This project involves the demolition of existing roadway lighting, deteriorated railings, deteriorated walkways, and the removal of approximately 220 trees.

B. Is any part of the project site an archaeological site listed in the State Register of Historic Places or the Inventory of Historic and Archaeological Assets of the Commonwealth? ___ Yes No; if yes, does the project involve the destruction of all or any part of such archaeological site? ___ Yes ___ No; if yes, please describe:

A Project Notification Form (PNF) has been filed with the Massachusetts Historical Commission (MHC). A copy of the PNF is included in Appendix E.

C. If you answered "No" to all parts of both questions A and B, proceed to the **Attachments and Certifications** Sections. If you answered "Yes" to any part of either question A or question B, fill out the remainder of the Historical and Archaeological Resources Section below.

D. Have you consulted with the Massachusetts Historical Commission? Yes ___ No; if yes, attach correspondence

A Project Notification Form (PNF) has been filed with the Massachusetts Historical Commission (MHC). A copy of the PNF is included in Appendix E.

E. Describe and assess the project's other impacts, direct and indirect, on listed or inventoried historical and archaeological resources:

A Project Notification Form (PNF) has been filed with the Massachusetts Historical Commission (MHC). A copy of the PNF is included in Appendix E.

II. **Consistency** -- Describe measures that the proponent will take to comply with federal, state, regional, and local plans and policies related to preserving historical and archaeological resources:

The proposed project is consistent with the Charles River Master Plan.



BEGIN PHASE II

END PHASE II

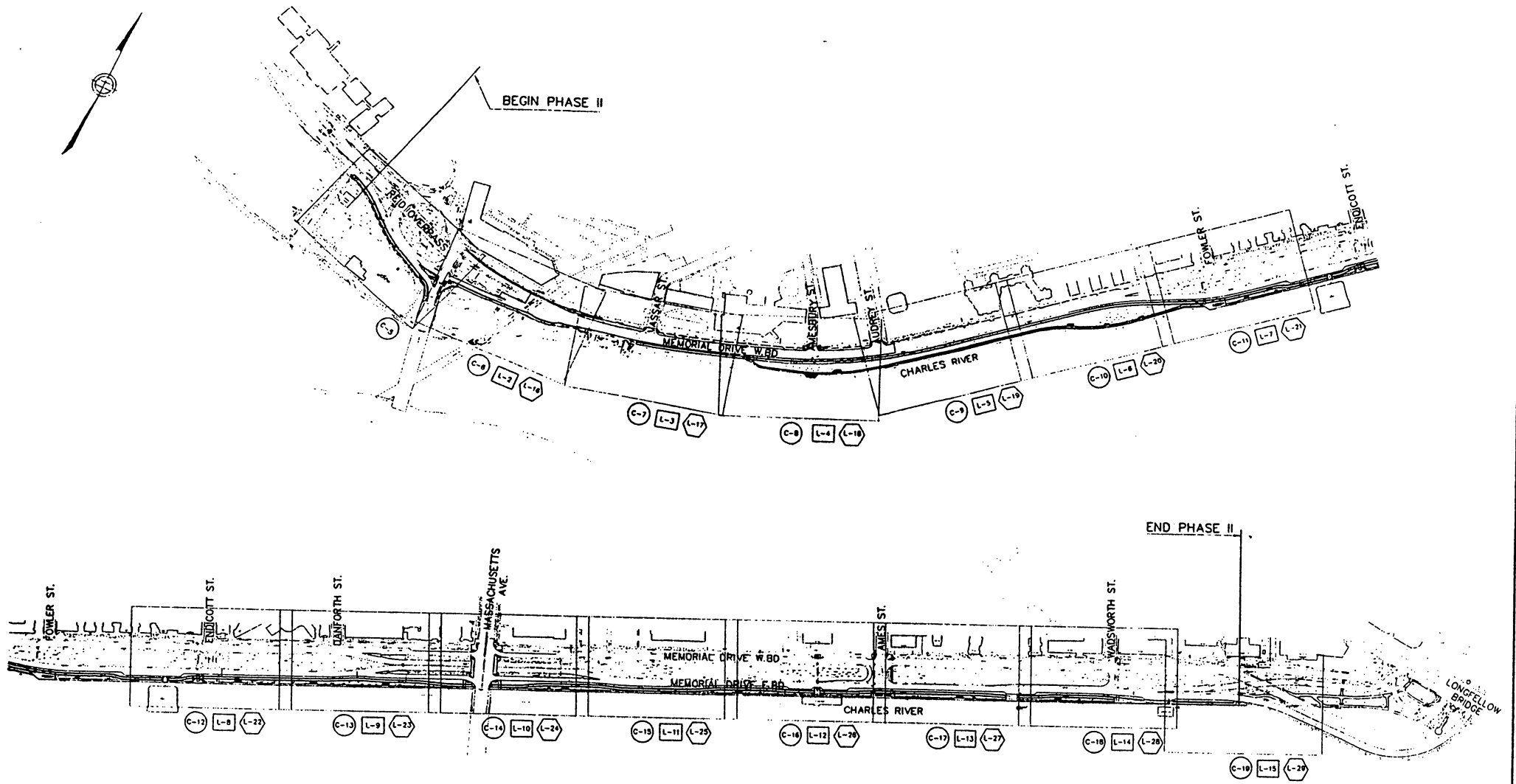

LEGEND

- GENERAL PLAN
- LANDSCAPING PLAN
- ⬡ TREE REMOVAL AND PROTECTION PLAN

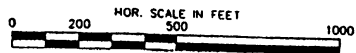





COMMONWEALTH OF MASSACHUSETTS
METROPOLITAN DISTRICT COMMISSION
ENGINEERING AND CONSTRUCTION

HISTORIC PARKWAYS INITIATIVE
MEMORIAL DRIVE DEMONSTRATION PROJECT PHASE II
CAMBRIDGE, MASSACHUSETTS

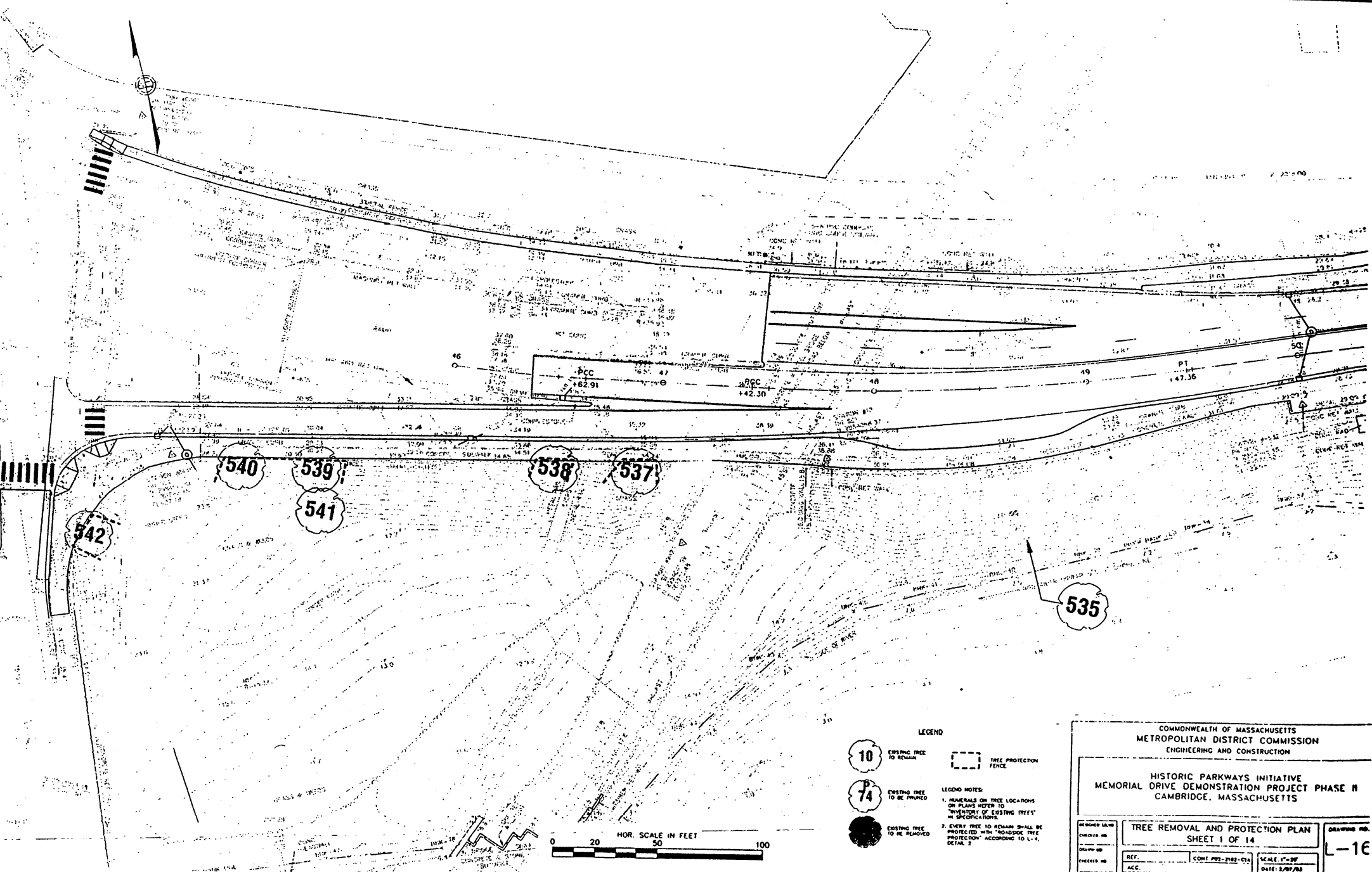
DESIGNED BY CHECKED BY	KEY PLAN	DRAWING NO. G-4
DRAWN BY CHECKED BY		REF. _____ ACC. _____
COMT. P02-2102-C1A		SCALE: 1"=200' DATE: 3/31/03

METROPOLITAN DISTRICT COMMISSION
20 SOMERSET STREET

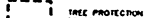

- LEGEND**
-  EXISTING TREE TO REMAIN
 -  EXISTING TREE TO BE PRUNED
 -  EXISTING TREE TO BE REMOVED
 -  TREE PROTECTION FENCE
- LEGEND NOTES:**
1. NUMERALS ON TREE LOCATIONS ON PLANS REFER TO 'INVENTORY OF EXISTING TREES' IN SPECIFICATIONS.
 2. EVERY TREE TO REMAIN SHALL BE PROTECTED WITH 'ROADSIDE TREE PROTECTION' ACCORDING TO L-4, DETAIL 2.

COMMONWEALTH OF MASSACHUSETTS
METROPOLITAN DISTRICT COMMISSION
ENGINEERING AND CONSTRUCTION

**HISTORIC PARKWAYS INITIATIVE
MEMORIAL DRIVE DEMONSTRATION PROJECT PHASE II
CAMBRIDGE, MASSACHUSETTS**

DRAWN BY	TREE REMOVAL AND PROTECTION PLAN	DRAWING NO.
CHECKED BY	SHEET 1 OF 14	L-16
REF.	CONTRACT NO. 92-202-C1A	SCALE 1"=20'
ACC.	DATE: 2/27/83	

METROPOLITAN DISTRICT COMMISSION
90 CONSUMERS STREET



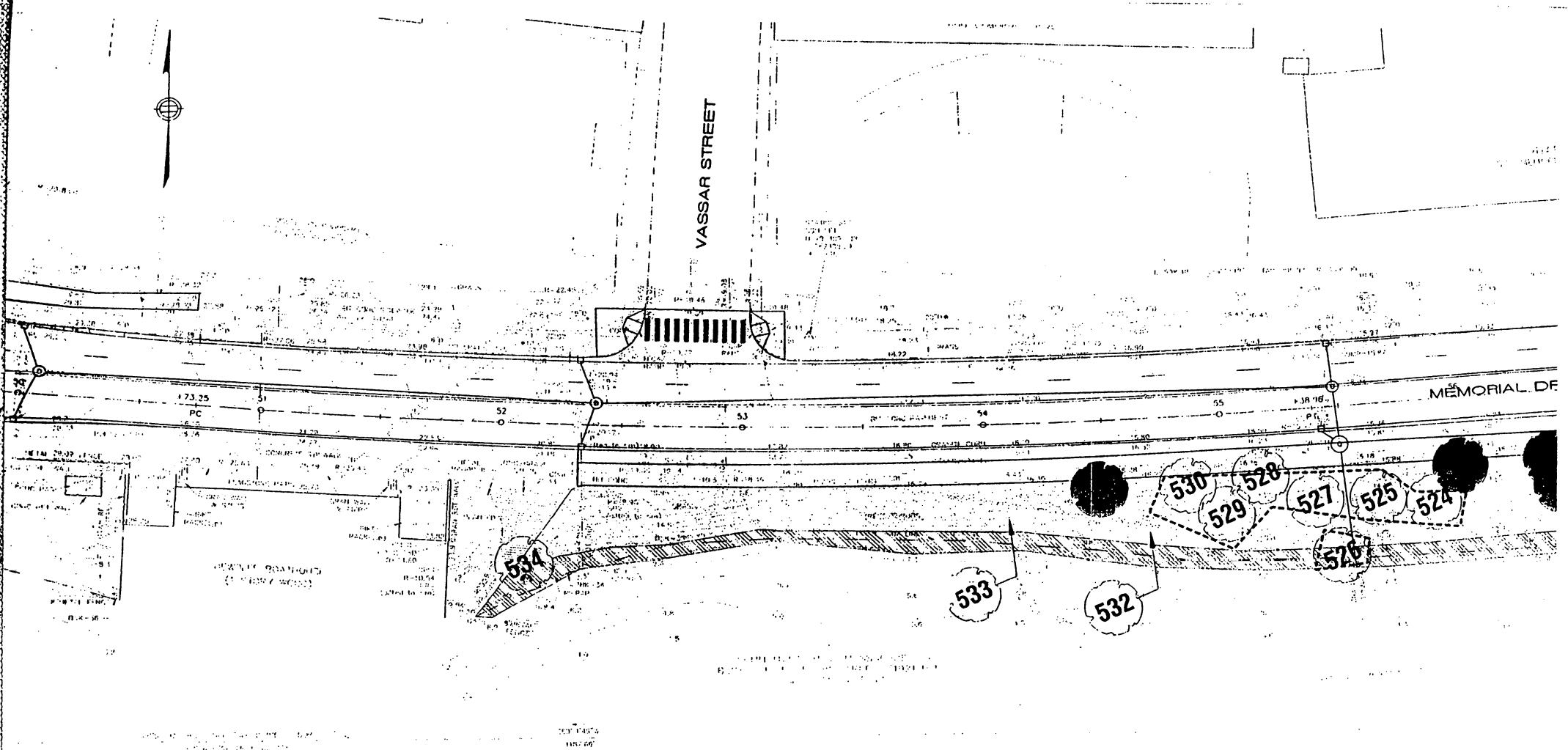

VASSAR STREET

MEMORIAL DRIVE

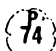

LEGEND

-  EXISTING TREE TO REMAIN
 -  EXISTING TREE TO BE PRESERVED
 -  EXISTING TREE TO BE REMOVED
 -  TREE PROTECTION FENCE
- LEGEND NOTES:
1. NUMBERS ON TREE LOCATIONS ON PLANS REFER TO "NUMBERS OF EXISTING TREES" IN SPECIFICATIONS.
 2. EVERY TREE TO REMAIN SHALL BE PROTECTED WITH "ROADSIDE TREE PROTECTION" ACCORDING TO L-4, DETAIL 2.

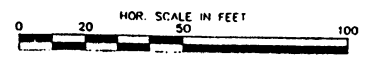

COMMONWEALTH OF MASSACHUSETTS
METROPOLITAN DISTRICT COMMISSION
ENGINEERING AND CONSTRUCTION

HISTORIC PARKWAYS INITIATIVE
MEMORIAL DRIVE DEMONSTRATION PROJECT PHASE II
CAMBRIDGE, MASSACHUSETTS

DESIGNED BY	PROJECT NO.	SCALE	DRAWING NO.
DRAWN BY	CONTRACT NO.	DATE	
CHECKED BY	DATE		

TREE REMOVAL AND PROTECTION PLAN
SHEET 2 OF 14

METROPOLITAN DISTRICT COMMISSION
20 SOMERSET STREET
BOSTON, MA 02108

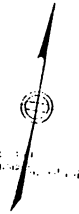

AMESBURY STREET

AUDREY STREET

MEMORIAL DRIVE

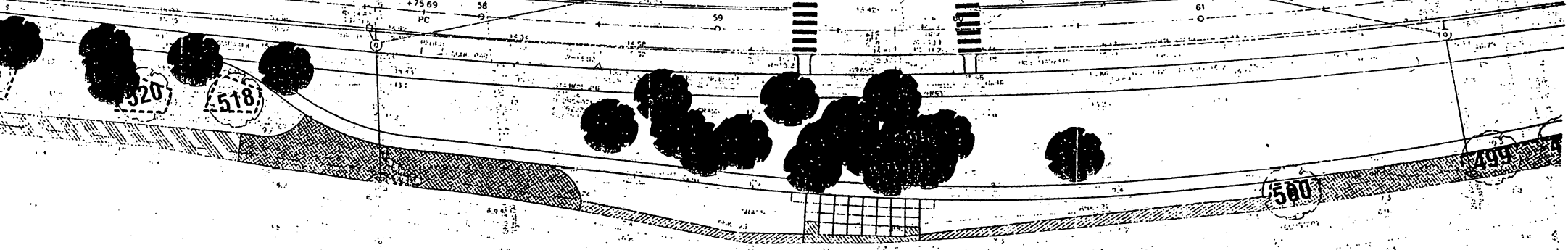

LEGEND



EXISTING TREE TO REMAIN



TREE PROTECTION FENCE



EXISTING TREE TO BE REMOVED



EXISTING TREE TO BE REMOVED

LEGEND NOTES:
1. NUMERALS ON TREE LOCATIONS ON PLANS REFER TO "NUMBERS OF EXISTING TREES" IN SPECIFICATIONS.
2. EVERY TREE TO REMAIN SHALL BE PROTECTED WITH "ROADSIDE TREE PROTECTION" ACCORDING TO L-4, DETAIL 2.

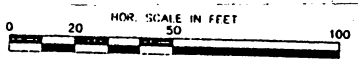

COMMONWEALTH OF MASSACHUSETTS
METROPOLITAN DISTRICT COMMISSION
ENGINEERING AND CONSTRUCTION

HISTORIC PARKWAYS INITIATIVE
MEMORIAL DRIVE DEMONSTRATION PROJECT PHASE II
CAMBRIDGE, MASSACHUSETTS

DESIGNED BY	TREE REMOVAL AND PROTECTION PLAN SHEET 3 OF 14	DRAWING NO.
CHECKED BY		L-1E
REF.	CONTRACT: P02-2102-01A	SCALE: 1"=20'
ACC.		DATE: 2/07/03

METROPOLITAN DISTRICT COMMISSION

ANDREY STREET

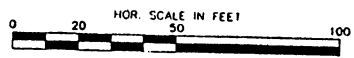
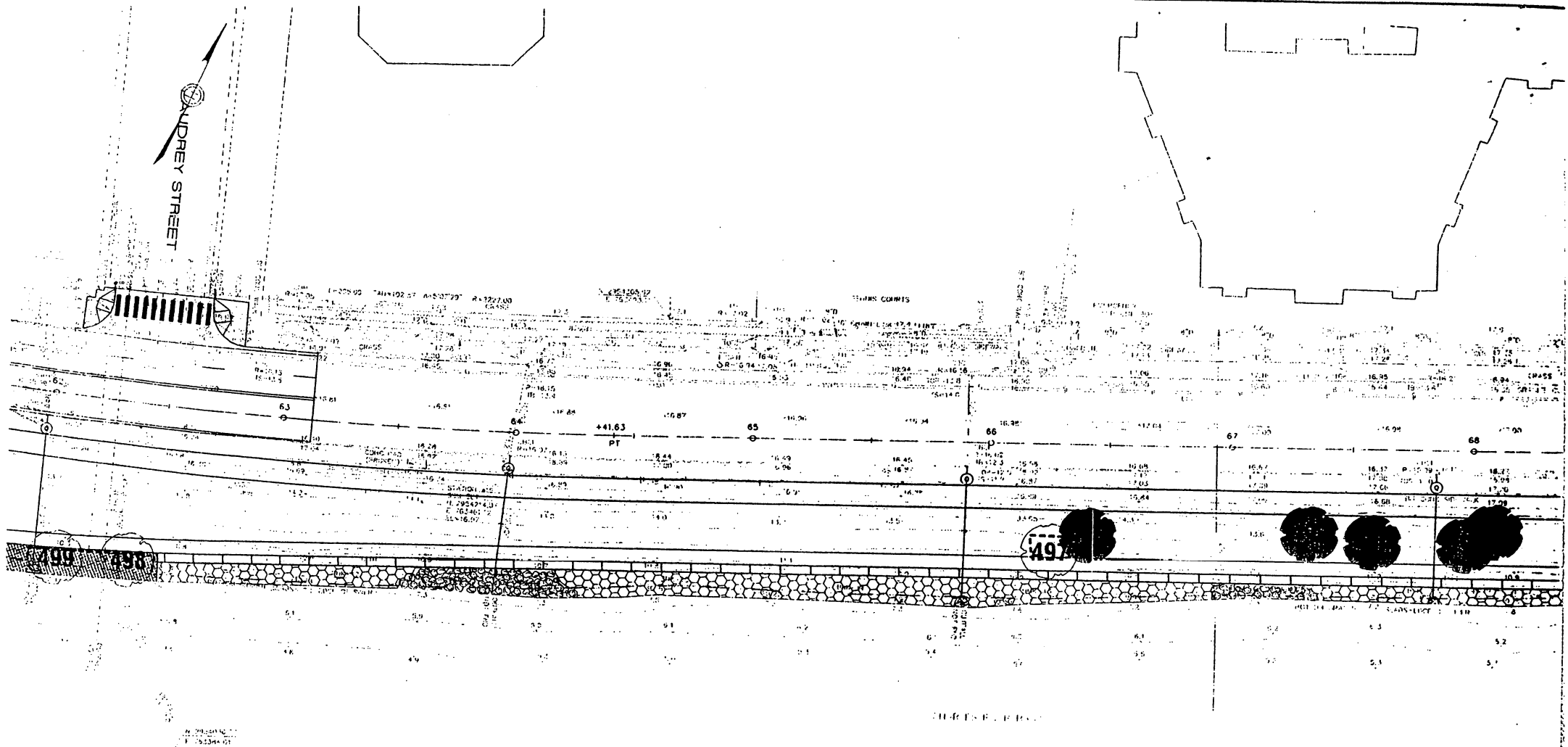

LEGEND

10 EXISTING TREE TO REMAIN

74 EXISTING TREE TO BE PRUNED

EXISTING TREE TO BE REMOVED

TREE PROTECTION FENCE

LEGEND NOTES

1. NUMERALS ON TREE LOCATIONS OR PLANS REFER TO "INVENTORY OF EXISTING TREES" BY SPECIFICATOR

2. EVERY TREE TO REMAIN SHALL BE PROTECTED WITH "ROADSIDE TREE PROTECTION" ACCORDING TO L-4, DETAIL 2

COMMONWEALTH OF MASSACHUSETTS
METROPOLITAN DISTRICT COMMISSION
ENGINEERING AND CONSTRUCTION

HISTORIC PARKWAYS INITIATIVE
MEMORIAL DRIVE DEMONSTRATION PROJECT PHASE
CAMBRIDGE, MASSACHUSETTS

TREE REMOVAL AND PROTECTION PLAN
SHEET 4 OF 14

APPROVED BY: []
CHECKED BY: []
DATE: 8/07/03

SCALE: 1"=20'

DATE: 8/07/03

METROPOLITAN DISTRICT COMMISSION
20 SOUTH STREET

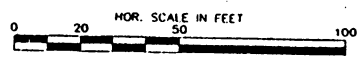
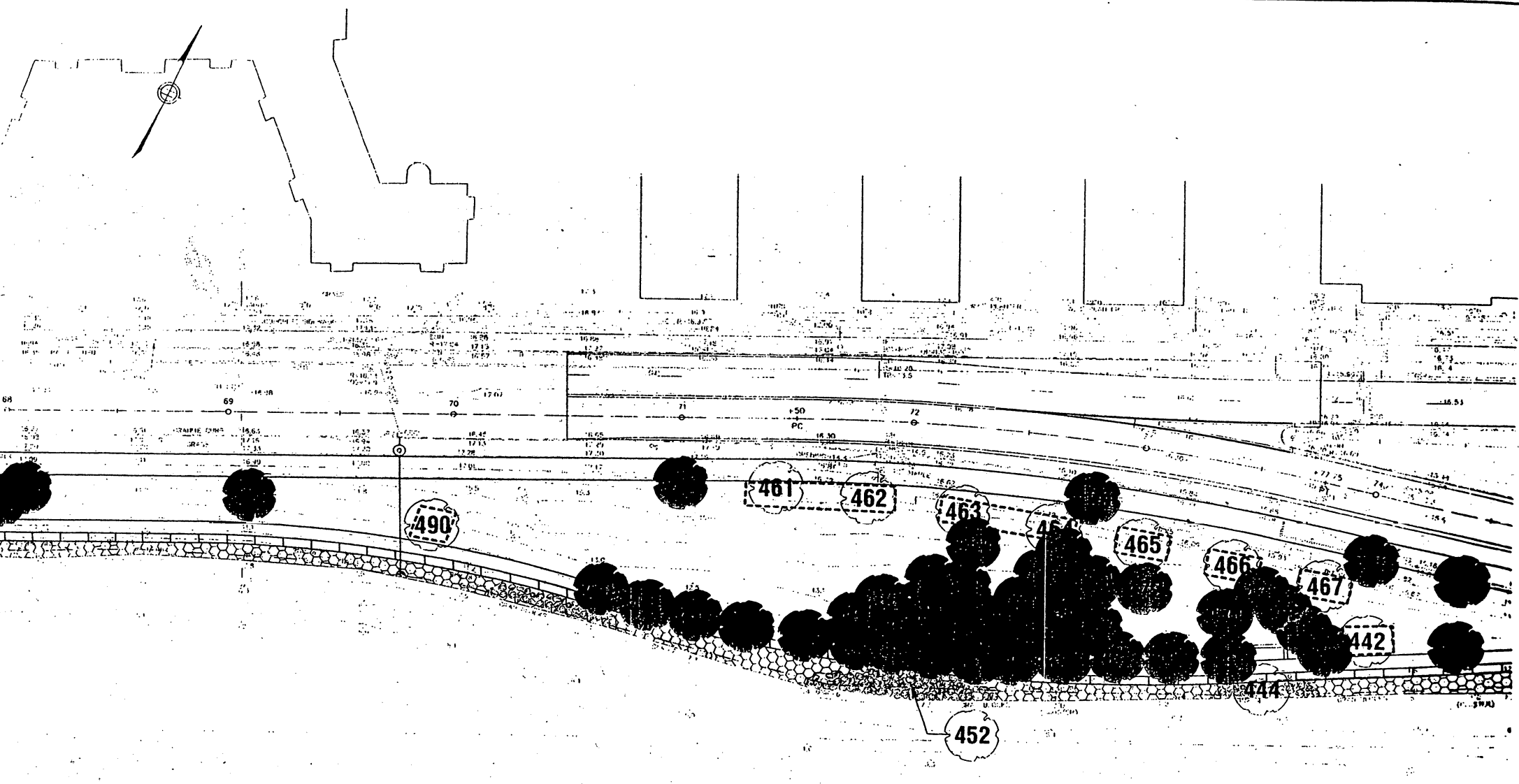

- LEGEND**
- 10 EXISTING TREE TO REMAIN
 - 74 EXISTING TREE TO BE PRUNED
 - EXISTING TREE TO BE REMOVED
 - TREE PROTECTION FENCE
- LEGEND NOTES:**
1. NUMERALS ON TREE LOCATIONS ON PLANS REFER TO INVENTORY OF EXISTING TREES IN SPECIFICATIONS
 2. EVERY TREE TO REMAIN SHALL BE PROTECTED WITH "ROADSIDE TREE PROTECTION" ACCORDING TO L-4, DETAIL 2

COMMONWEALTH OF MASSACHUSETTS
METROPOLITAN DISTRICT COMMISSION
ENGINEERING AND CONSTRUCTION

HISTORIC PARKWAYS INITIATIVE
MEMORIAL DRIVE DEMONSTRATION PROJECT PHASE II
CAMBRIDGE, MASSACHUSETTS

DESIGNED BY CHECKED BY	TREE REMOVAL AND PROTECTION PLAN SHEET 5 OF 14	DRAWING NO. -20
DATE: _____	SCALE: 1"=50' DATE: 2/07/03	

METROPOLITAN DISTRICT COMMISSION

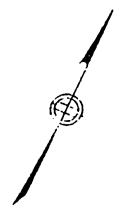

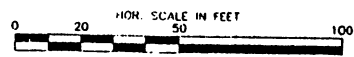
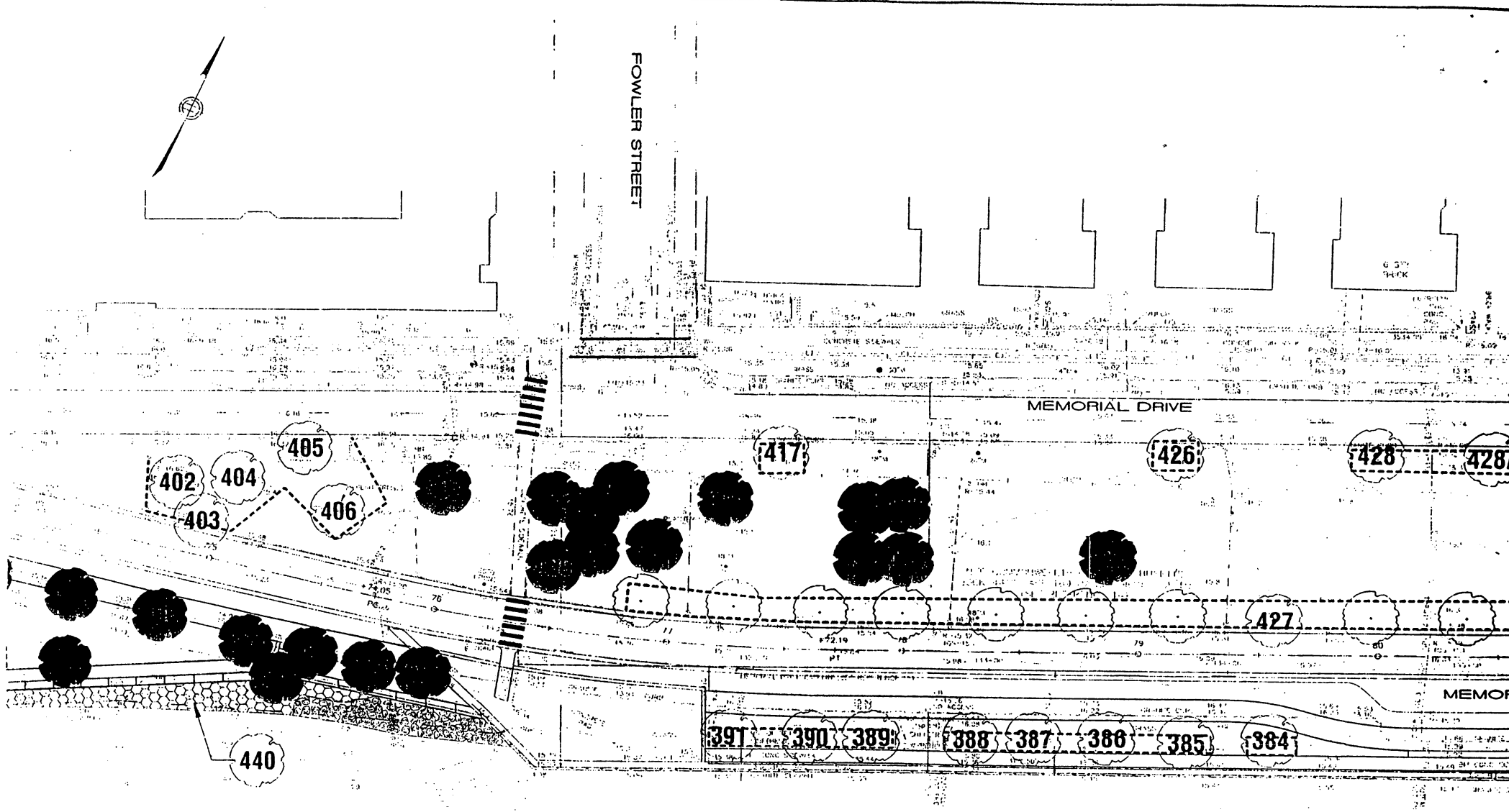

FOWLER STREET

MEMORIAL DRIVE

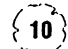
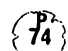

LEGEND

-  EXISTING TREE TO REMAIN
 -  EXISTING TREE TO BE PRUNED
 -  EXISTING TREE TO BE ALLOWED
 -  TREE PROTECTION FENCE
- LEGEND NOTES:
1. NUMBERS ON TREE LOCATIONS OR PLANS REFER TO "INVENTORY OF EXISTING TREES" IN SPECIFICATIONS
 2. EVERY TREE TO REMAIN SHALL BE PROTECTED WITH "WOODSIDE TREE PROTECTION" ACCORDING TO L-1, D-T-17.

COMMONWEALTH OF MASSACHUSETTS
METROPOLITAN DISTRICT COMMISSION
ENGINEERING AND CONSTRUCTION

HISTORIC PARKWAYS INITIATIVE
MEMORIAL DRIVE DEMONSTRATION PROJECT
CAMBRIDGE, MASSACHUSETTS

TREE REMOVAL AND PROTECTION PLAN
SHEET 6 OF 14





REF: CON1 P02-202-C1A
SCALE: 1"=20'
DATE: 2/97/83

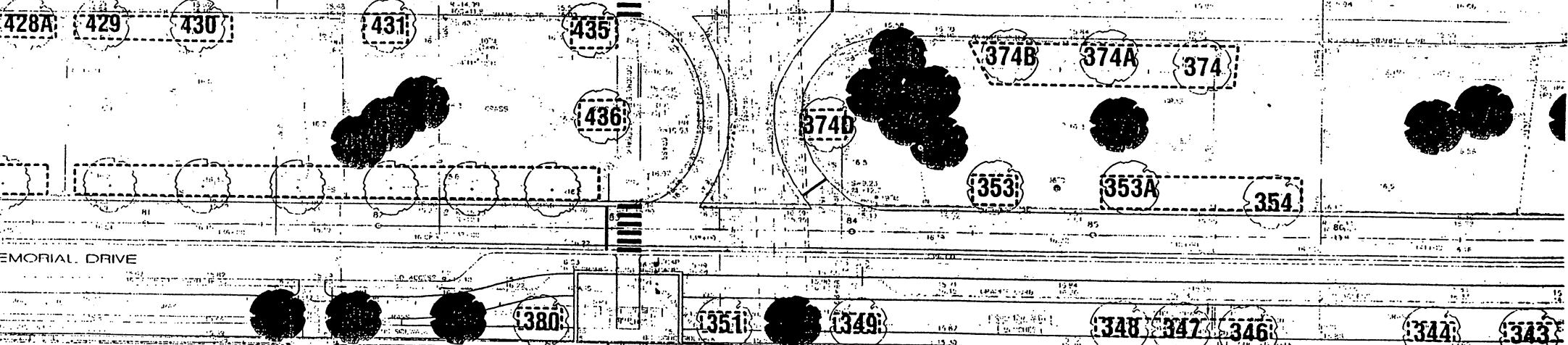

ENDICOTT STREET



LEGEND

-  EXISTING TREE TO REMAIN
 -  EXISTING TREE TO BE PRUNED
 -  EXISTING TREE TO BE REMOVED
 -  TREE PROTECTION FENCE
- LEGEND NOTES:
1. NUMERALS ON TREE LOCATIONS OR PLANS REFER TO "INVENTORY OF EXISTING TREES" IN SPECIFICATIONS.
 2. EVERY TREE TO REMAIN SHALL BE PROTECTED WITH "ROADSIDE TREE PROTECTION" ACCORDING TO L-4, DETAIL 2.

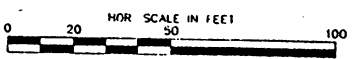

COMMONWEALTH OF MASSACHUSETTS
METROPOLITAN DISTRICT COMMISSION
ENGINEERING AND CONSTRUCTION

HISTORIC PARKWAYS INITIATIVE
MEMORIAL DRIVE DEMONSTRATION PROJECT PHASE II
CAMBRIDGE, MASSACHUSETTS

DESIGNED BY	TREE REMOVAL AND PROTECTION PLAN	DRAWING NO.
CHECKED BY	SHEET 7 OF 14	-2-
DATE	SCALE: 1"=30'	
REF.	CONTRACT: P22-202-01A	DATE: 2/07/83
ACC.	METROPOLITAN DISTRICT COMMISSION	

ANFORTH STREET

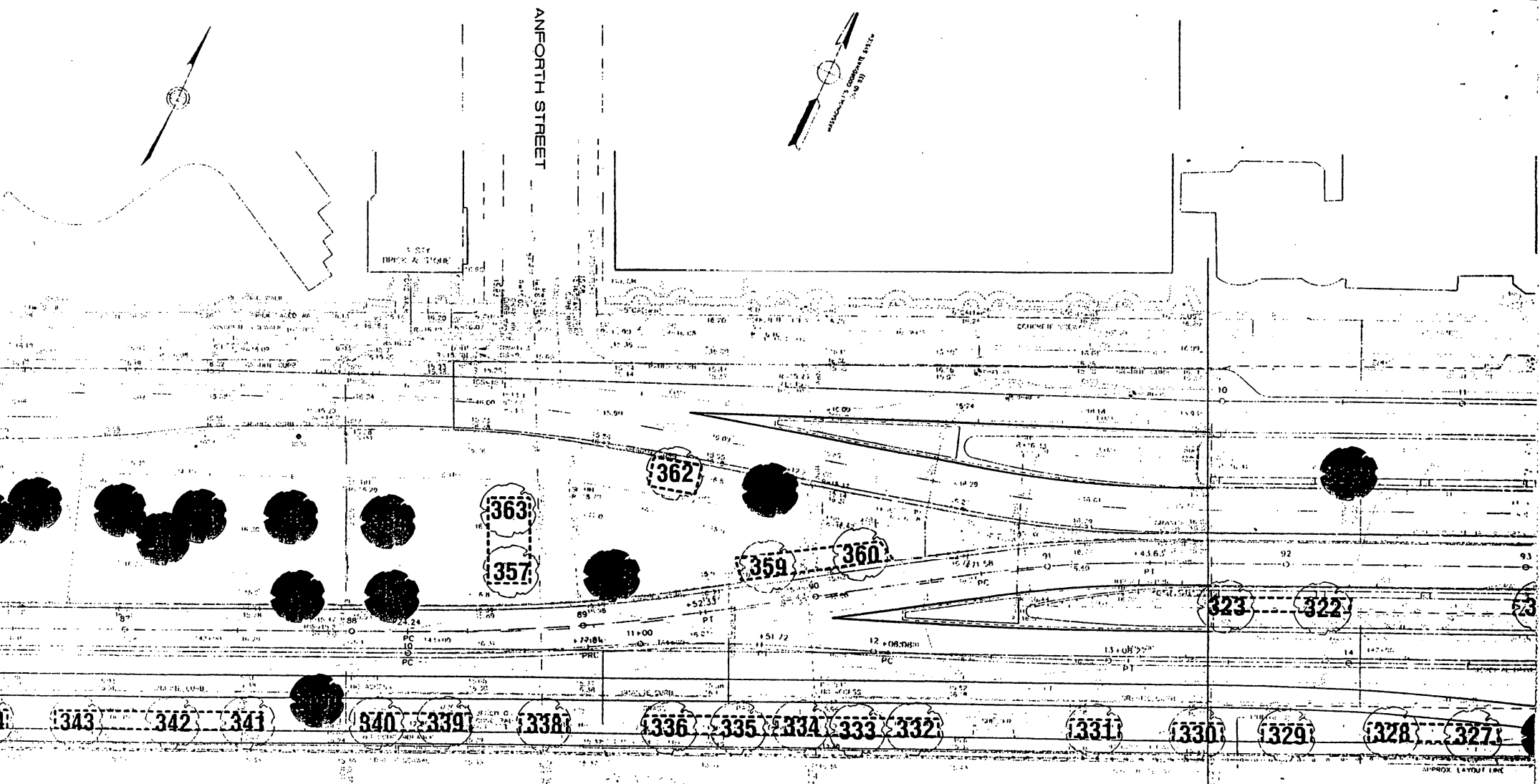
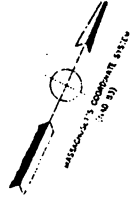

DETAIL
N13

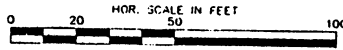

- LEGEND**
- 10 EXISTING TREE TO REMAIN
 - P/4 EXISTING TREE TO BE PRUNED
 - EXISTING TREE TO BE REMOVED
 - TREE PROTECTION FENCE
- LEGEND NOTES**
1. NUMERALS ON TREE LOCATIONS OR PLANS REFER TO "INVENTORY OF EXISTING TREES" BY SPECIFICATIONS
 2. EVERY TREE TO REMAIN SHALL BE PROTECTED WITH "ROADSIDE TREE PROTECTION" ACCORDING TO L-1, DETAIL 2

COMMONWEALTH OF MASSACHUSETTS
METROPOLITAN DISTRICT COMMISSION
ENGINEERING AND CONSTRUCTION

HISTORIC PARKWAYS INITIATIVE
MEMORIAL DRIVE DEMONSTRATION PROJECT PHASE
CAMBRIDGE, MASSACHUSETTS



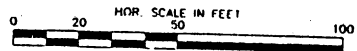
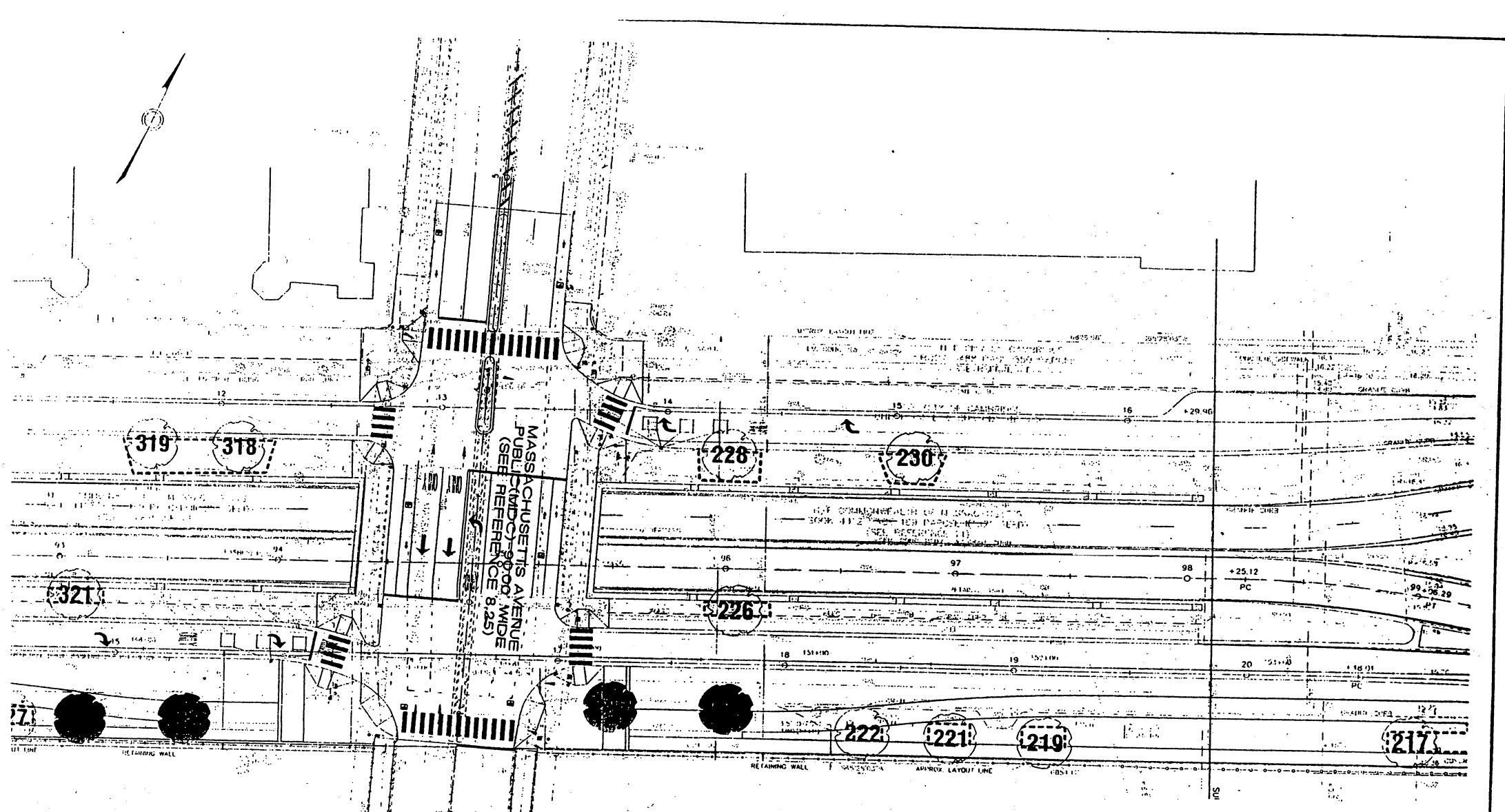

TREE REMOVAL AND PROTECTION PLAN
SHEET 8 OF 14

DESIGNED BY	CHKD BY	DATE
DRAWN BY	ACC.	DATE
PROJECT NO.	CONTRACT NO.	DATE

METROPOLITAN DISTRICT COMMISSION
20 SOMERSET STREET
BOSTON, MA. 02108



CHARLES RIVER

- LEGEND**
-  EXISTING TREE TO REMAIN
 -  EXISTING TREE TO BE PRUNED
 -  EXISTING TREE TO BE REMOVED
 -  TREE PROTECTION FENCE
- LEGEND NOTES:**
1. NUMERALS ON TREE LOCATIONS ON PLANS REFER TO "INVENTORY OF EXISTING TREES" IN SPECIFICATIONS.
 2. EVERY TREE TO REMAIN SHALL BE PROTECTED WITH "ROADSIDE TREE PROTECTION" ACCORDING TO L-4, DETAIL 2.

COMMONWEALTH OF MASSACHUSETTS
METROPOLITAN DISTRICT COMMISSION
ENGINEERING AND CONSTRUCTION

**HISTORIC PARKWAYS INITIATIVE
MEMORIAL DRIVE DEMONSTRATION PROJECT PHASE II
CAMBRIDGE, MASSACHUSETTS**

DESIGNED BY CHECKED BY	TREE REMOVAL AND PROTECTION PLAN SHEET 9 OF 14	DRAWING NO. -24
DRAWN BY	REF. CON1_P02-2182-01A	SCALE: 1"=20'
CHECKED BY	ACC.	DATE: 2/07/03

METROPOLITAN DISTRICT COMMISSION
20 SAUNDERS STREET

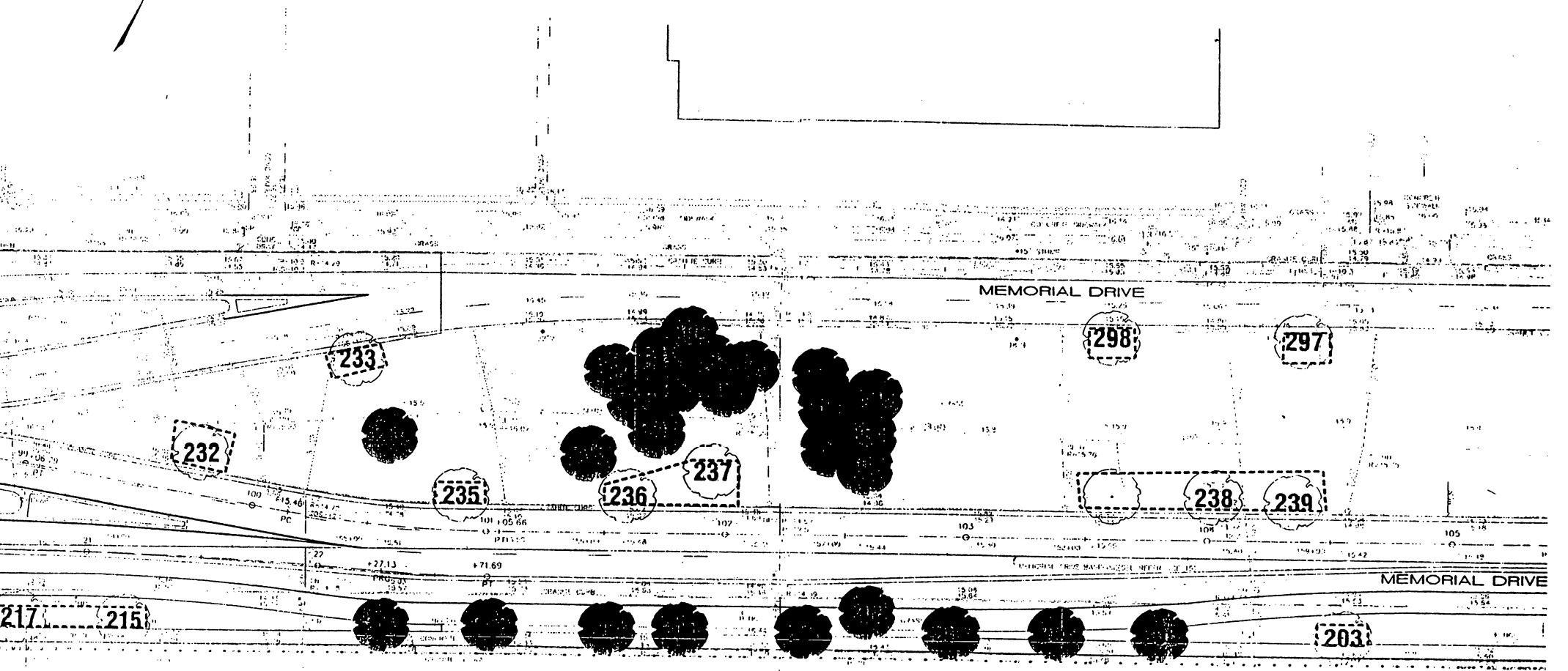
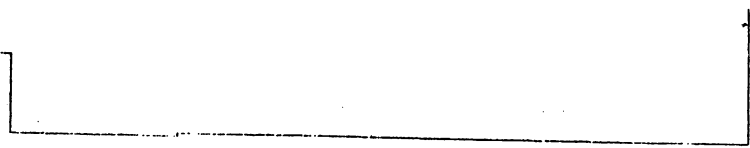
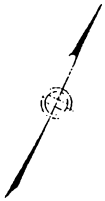

MEMORIAL DRIVE

MEMORIAL DRIVE



EXISTING TREE TO REMAIN



EXISTING TREE TO BE REMOVED



EXISTING TREE TO BE REMOVED



TREE PROTECTION FENCE

LEGEND NOTES:
1. NUMERALS ON TREE LOCATIONS OR PLANTS REFER TO 'INVENTORY OF EXISTING TREES' IN SPECIFICATIONS.
2. EVERY TREE TO REMAIN SHALL BE PROTECTED WITH 'ROADSIDE TREE PROTECTION' ACCORDING TO L-4, DETAIL 7.

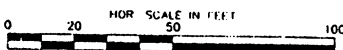

COMMONWEALTH OF MASSACHUSETTS
METROPOLITAN DISTRICT COMMISSION
ENGINEERING AND CONSTRUCTION

HISTORIC PARKWAYS INITIATIVE
MEMORIAL DRIVE DEMONSTRATION PROJECT PHASE II
CAMBRIDGE, MASSACHUSETTS



DESIGNED BY DATE	TREE REMOVAL AND PROTECTION PLAN SHEET 10 OF 14	DRAWING NO. -25
CHECKED BY DATE	REF. ACC. COM1 P22-2192-01A SCALE: 1"=20' DATE: 2/9/93	

METROPOLITAN DISTRICT COMMISSION
20 SOMERSET STREET

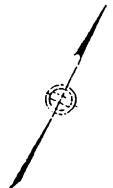
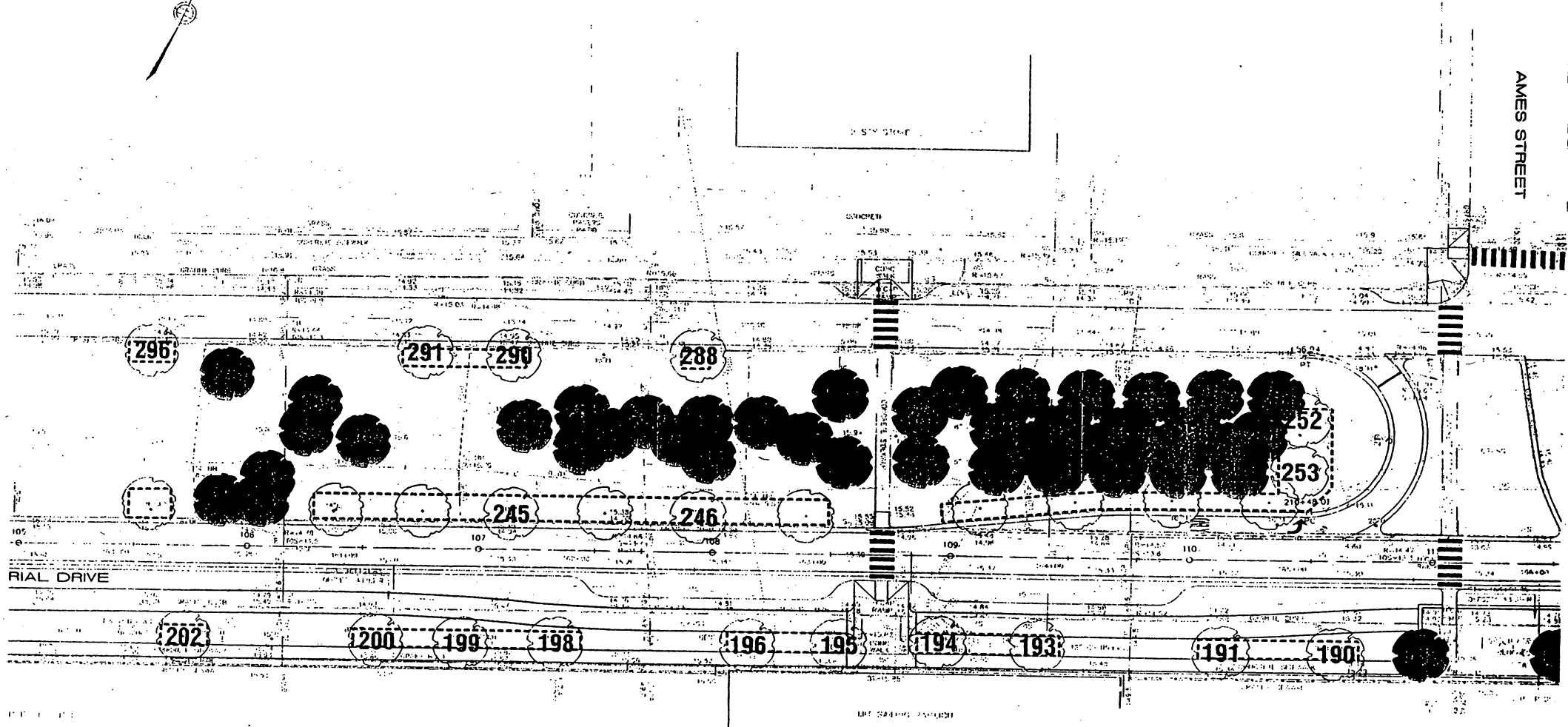
AMES STREET

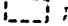

LEGEND

-  EXISTING TREE TO REMAIN
 -  EXISTING TREE TO BE PRUNED
 -  EXISTING TREE TO BE REMOVED
 -  TREE PROTECTION FENCE
- LEGEND NOTES:
1. NUMERALS ON TREE LOCATIONS OR PLANS REFER TO "INVENTORY OF EXISTING TREES" BY SPECIFICATIONS.
 2. EVERY TREE TO REMAIN SHALL BE PROTECTED WITH "ROADSIDE TREE PROTECTION" ACCORDING TO 1-1-1 DETAIL 2.

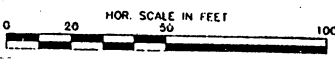

COMMONWEALTH OF MASSACHUSETTS
METROPOLITAN DISTRICT COMMISSION
ENGINEERING AND CONSTRUCTION

HISTORIC PARKWAYS INITIATIVE
MEMORIAL DRIVE DEMONSTRATION PROJECT PHASE II
CAMBRIDGE, MASSACHUSETTS

<small>REVISION NUMBER</small>	TREE REMOVAL AND PROTECTION PLAN	<small>DRAWING NO.</small>
<small>CHECKED BY</small>	SHEET 11 OF 14	-26-
<small>DATE</small>	<small>REF.</small> <small>CONT. P22-2182-D1A</small> <small>SCALE: 1"=20'</small>	<small>DATE: 2/27/03</small>
<small>CHECKED BY</small>	<small>ACC.</small>	<small>DATE: 2/27/03</small>

METROPOLITAN DISTRICT COMMISSION

AMES STREET

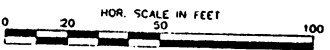
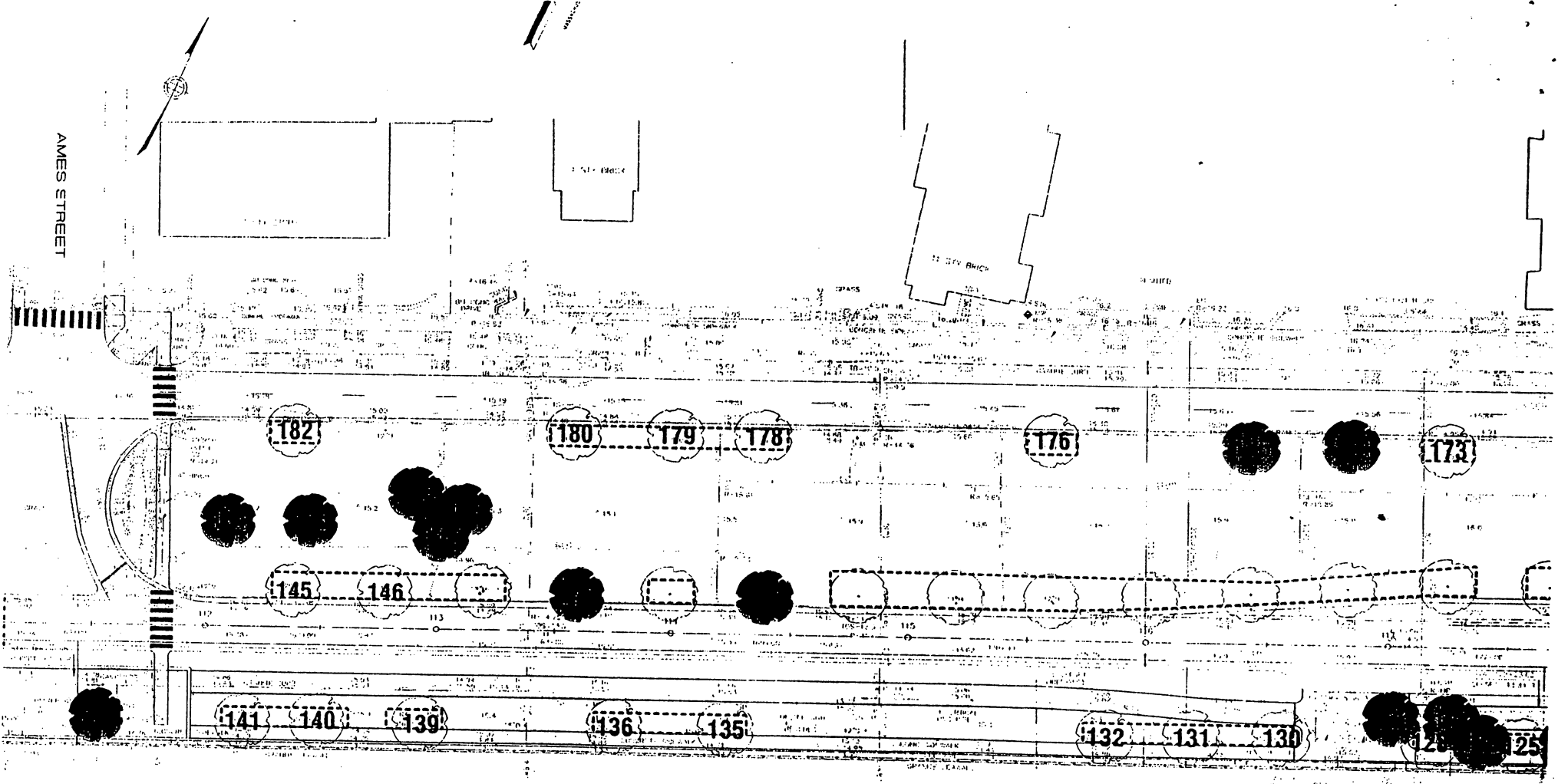

LEGEND

10 EXISTING TREE TO REMAIN

74 EXISTING TREE TO BE PRUNED

● EXISTING TREE TO BE REMOVED

--- TREE PROTECTION FENCE

LEGEND NOTES:

1. MANIPULATION OF TREE LOCATIONS OR PLANTS REFER TO 'INVENTORY OF EXISTING TREES' IN SPECIFICATIONS.
2. EVERY TREE TO REMAIN SHALL BE PROTECTED WITH 'WOODSIE TREE PROTECTION' ACCORDING TO L.S.A. DETAIL 2.

COMMONWEALTH OF MASSACHUSETTS
METROPOLITAN DISTRICT COMMISSION
ENGINEERING AND CONSTRUCTION

HISTORIC PARKWAYS INITIATIVE
MEMORIAL DRIVE DEMONSTRATION PROJECT PHASE II
CAMBRIDGE, MASSACHUSETTS

TREE REMOVAL AND PROTECTION PLAN
SHEET 12 OF 14

DESIGNED BY	NO. E.C. 20	DRAWING NO.
CHECKED BY	DATE: 1/27/02	- 27
APPROVED BY	ACC.	

METROPOLITAN DISTRICT COMMISSION
70 SAFFORD STREET

WORTH STREET

MEMORIAL DRIVE



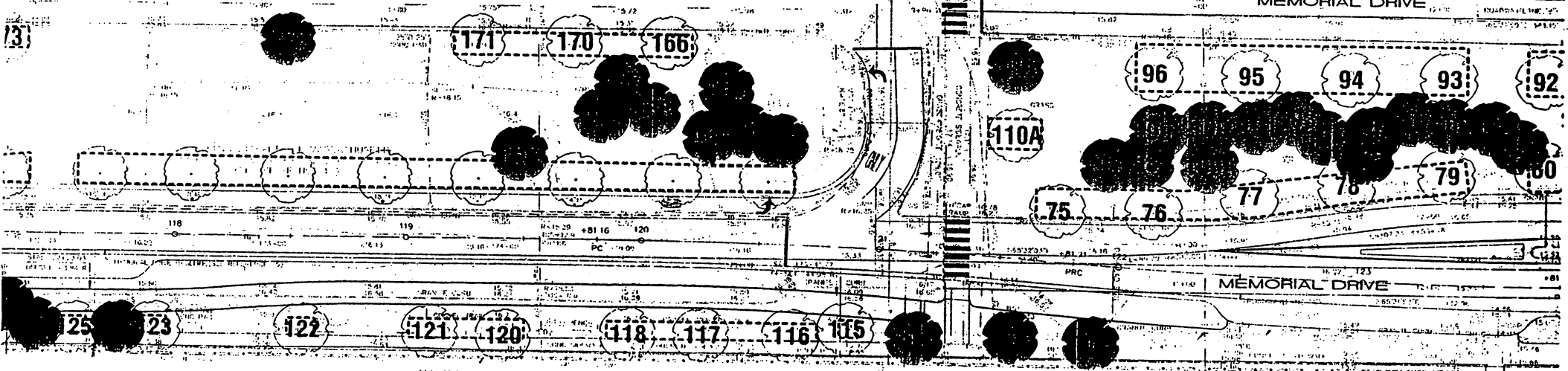

MEMORIAL DRIVE

13



DETAIL
SCALE

LEGEND

-  EXISTING TREE TO REMAIN
 -  EXISTING TREE TO BE PLANTED
 -  EXISTING TREE TO BE REMOVED
 -  TREE PROTECTION FENCE
- LEGEND NOTES:
1. NUMBERS ON TREE LOCATIONS ON PLANS REFER TO "INVENTORY OF EXISTING TREES" IN SPECIFICATIONS.
 2. EVERY TREE TO REMAIN SHALL BE PROTECTED WITH "ROADSIDE TREE PROTECTION" ACCORDING TO L-4, DETAIL 2.

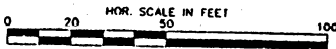

COMMONWEALTH OF MASSACHUSETTS
METROPOLITAN DISTRICT COMMISSION
ENGINEERING AND CONSTRUCTION

HISTORIC PARKWAYS INITIATIVE
MEMORIAL DRIVE DEMONSTRATION PROJECT PHASE II
CAMBRIDGE, MASSACHUSETTS

DESIGNED BY	TREE REMOVAL AND PROTECTION PLAN		DRAWING NO.
CHECKED BY	SHEET 13 OF 14		-28-
DATE	REF.	SCALE 1/4" = 1'-0"	DATE 2/27/03
PROJECT NO.	ACC.	LOCAL 102-117-01A	DATE 2/27/03

METROPOLITAN DISTRICT COMMISSION

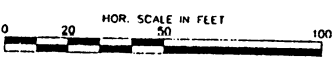
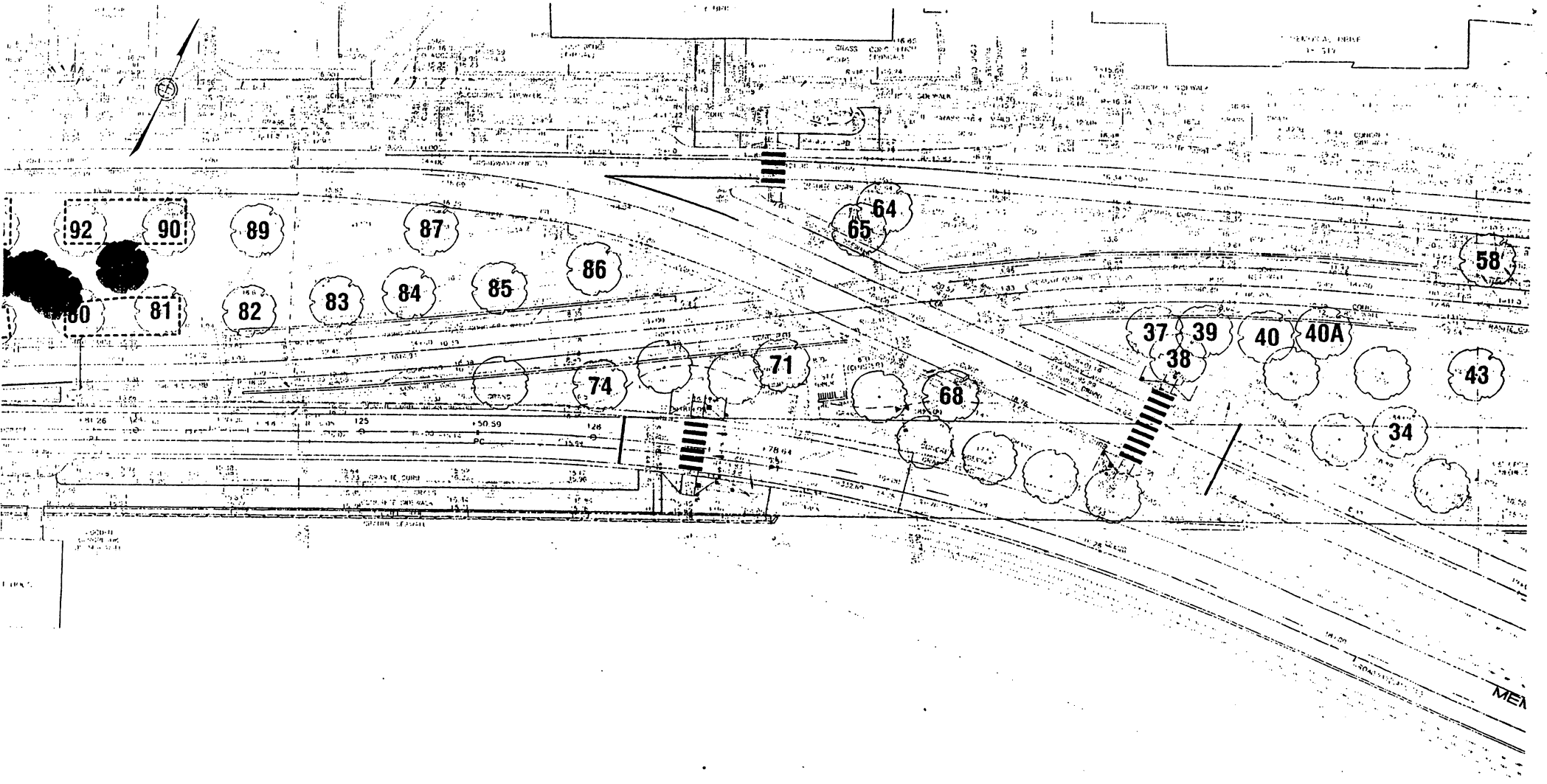

LEGEND

EXISTING TREE TO REMAIN
 EXISTING TREE TO BE PRUNED
 EXISTING TREE TO BE REMOVED
 TREE PROTECTION FENCE

LEGEND NOTES

1. MATERIALS ON TREE LOCATIONS ON PLANS REFER TO "VENTORY OF EXISTING TREES" IN SPECIFICATIONS.
2. EVERY TREE TO REMAIN SHALL BE PROTECTED WITH "ROADSIDE TREE PROTECTION" ACCORDING TO L.A. DETM 7.

COMMONWEALTH OF MASSACHUSETTS
 METROPOLITAN DISTRICT COMMISSION
 ENGINEERING AND CONSTRUCTION

HISTORIC PARKWAYS INITIATIVE
 MEMORIAL DRIVE DEMONSTRATION PROJECT PHASE II
 CAMBRIDGE, MASSACHUSETTS

DESIGNED BY	TREE REMOVAL AND PROTECTION PLAN SHEET 14 OF 14	DRAWING NO.
CHECKED BY		L-29
DATE		
REF. ACC.	COM. P02-2102-01A SCALE: 1"=40' DATE: 2/07/03	

METROPOLITAN DISTRICT COMMISSION



City of Cambridge

O-19
IN CITY COUNCIL
September 8, 2003

VICE MAYOR DAVIS
COUNCILLOR DECKER
COUNCILLOR GALLUCCIO
COUNCILLOR MAHER
COUNCILLOR MURPHY
COUNCILLOR REEVES
COUNCILLOR SIMMONS
MAYOR SULLIVAN
COUNCILLOR TOOMEY

- WHEREAS: Access to and activity along the riverfront open space in Cambridge may be limited by the duration that parking is allowed on Memorial Drive; and
- WHEREAS: Limiting the amount of time that one may park along the river could encourage more people to take advantage of the many benefits that this open space has to offer residents and visitors; now therefore be it
- ORDERED: That the City Manager engage the State Division of Urban Parks and Recreation in a conversation about the feasibility of limiting the duration of parking along Memorial Drive (for example, decreasing parking to two hours) and report back to the City Council with a recommendation.

In City Council September 8, 2003
Adopted by the affirmative vote of nine members.
Attest:- D. Margaret Drury, City Clerk

A true copy;

A handwritten signature in cursive script that reads "D. Margaret Drury".

ATTEST:-

D. Margaret Drury, City Clerk

CM220

ORDER#19

Requesting the City Manager engage the State Division of Urban Parks and Recreation in a conversation about the feasibility of limiting the duration of parking along Memorial Drive and report back to the City Council with a recommendation.

Vice Mayor Davis and entire membership

In City Council September 8, 2003

ORDER ADOPTED