



City of Cambridge

3.

IN CITY COUNCIL

February 6, 1995

COUNCILLOR SULLIVAN
VICE MAYOR RUSSELL
COUNCILLOR TOOMEY
COUNCILLOR BORN
COUNCILLOR DUEHAY
COUNCILLOR GALLUCCIO
COUNCILLOR MYERS
MAYOR REEVES
COUNCILLOR TRIANTAFILLOU

ORDERED: That the City Manager be and hereby is requested to refer the attached petition concerning the towing of cars from Riverside Road.

In City Council February 6, 1995
Adopted by the affirmative vote of seven members.
Attest:- D. Margaret Drury, City Clerk.

A true copy;

ATTEST:- *D. Margaret Drury*

D. Margaret Drury
City Clerk

MORSE SCHOOL
40 GRANITE STREET
CAMBRIDGE, MASSACHUSETTS 02139
1-617-349-6575

January 22, 1995

Mayor Kenneth Reeves
795 Massachusetts Avenue
Cambridge, MA. 02139

Dear Mayor Reeves:

The Stop & Shop Company, through their agents Pat's Towing, have been removing legally parked cars from a public street, Riverside Road. Both companies have been contacted on a number of occasions over the past few months but for whatever reason they continue to illegally take cars.

The staff at the Morse School, although desperately in need of street parking, have been intimidated to the point that they no longer use the street. This is also a City problem because the school is often used for public meetings and elections.

Would you please help us regain the use of this public street? We believe that Stop & Shop and Pat's Towing need to be put on notice that their actions will not be tolerated. It would also be helpful if the streets boundaries were properly marked with painted lines.

We thank you for any help or suggestions you may provide us.

Noreen E. O'Connell
Susan Anderson
Mitchell Kennedy
Shirley Sankton
Linda Rings
Diana Stedman

Sincerely,
Bill Foster
Alison Gagne
Joyce Cannon
Alison K. Hughes
Kate Donlon
Patricia Hanscom
Andrew J. Downie

cc: A. Thompson, R. Higley, T. Toomey, R. Dunphy, K. Born, S. Clippinger,
J. Myers, R. Scali, S. Russell, P. Murphy, M. Sullivan, S. Horowitz, R. Harris,
A. Fantini, T. Neighbor, J. Grassi, D. Kale, E. D. Simmons

Karen M. Allen
Maureen Partry
Paula Baptist
Donna K. Berkson

Leslie Caslette
Kathleen Reed (10/11)

Susan M. Bawbridge
Jean M. Clinton

Sybil Marie Key

Robert J. Casan

Lucy Walker

Margaret Walsh

Jeanne Gouere

Marilyn White

Dorothy Condon

Mary Alice

Lisa H.

Jinda O'Connor

Jean L. Toomey

Maurice L. Sauer

Julie Heandall
Patricia Lohette
Denise B. Hendry

Flora C. Crowley

Cheryl Jones
Maryann Walsh

Kathleen Foley

Sheila Penton

Bryce T.

Carl Rivers

Jim Coady

Karen Stapp



CITY OF CAMBRIDGE
Traffic and Parking
57 Inman Street,
Cambridge, Massachusetts 02139

Administration 349-4700
Parking Violations 349-4705
Resident Parking 349-4701

TO: BILL FORSTER

FROM: M. JANE FENT *MJF*

DATE: 14 DEC 1994

REF: RIVERSIDE PD

As discussed in earlier conversations, Riverside Rd. is a public way. The right of way is 40 feet wide and 624' long. Attached is a section of the city map which shows the location of Riverside Rd.

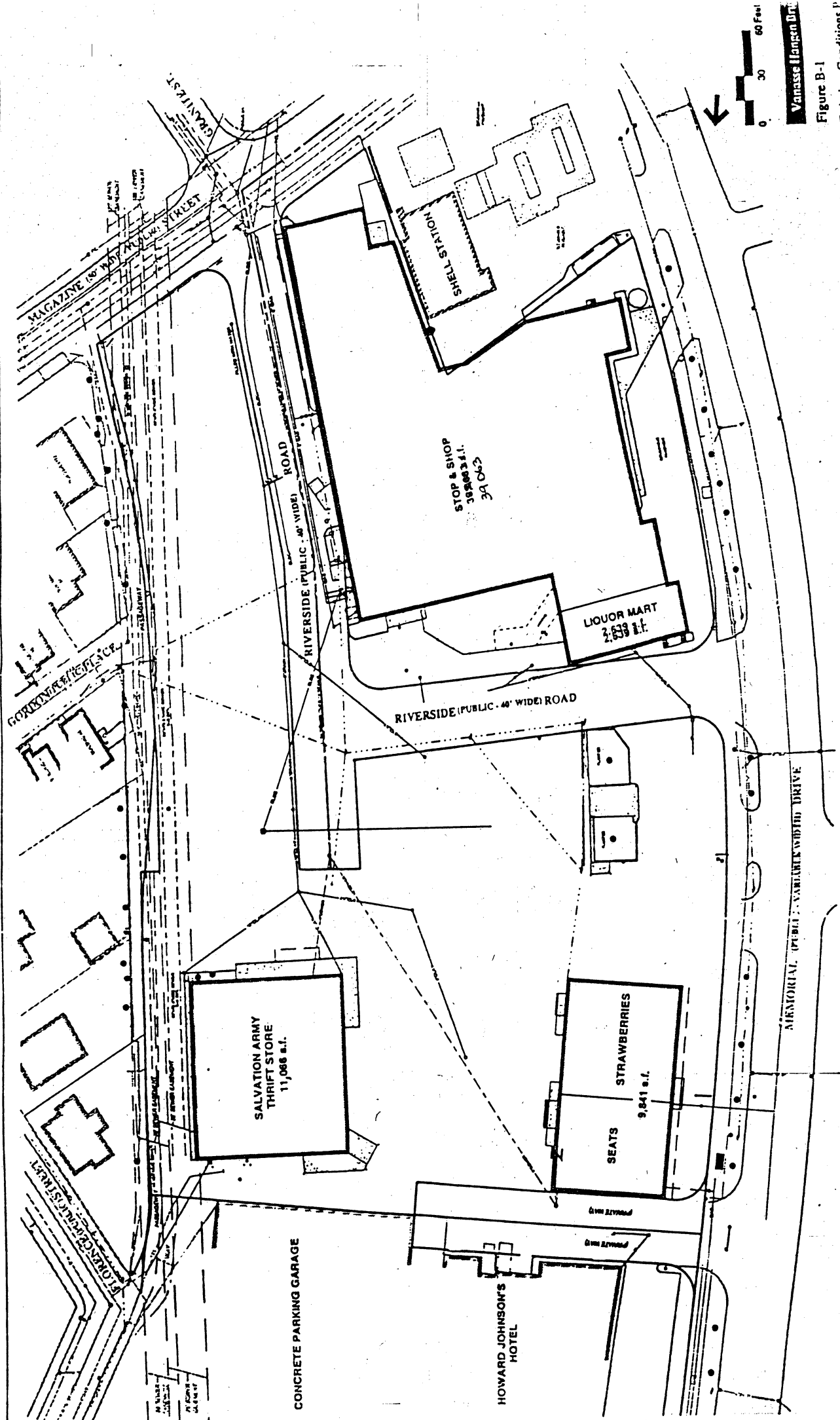

Vanasse Hansen Dnt
 Figure B-1
 Existing Conditions P



City of Cambridge

3.

IN CITY COUNCIL

February 6, 1995

COUNCILLOR SULLIVAN
VICE MAYOR RUSSELL
COUNCILLOR TOOMEY

ORDERED: That the City Manager be and hereby is requested to refer the attached petition concerning the towing of cars from Riverside Road.

Entire membership

CM38

Consent Order #3

Coun cillor Sullivan, Vice Mayor Russell re:
Cars being towed from Riverside Road.

In City Council February 6, 1995

Order adopted